

ARB AIR LOCKER *Air Operated Locking Differentials*

RD129 Toyota Tacoma,RR

Specs:

Axle Spline	30 tooth, Ø33.0mm [1.30"]
Ratio Supported	All
Ring Gear ID	127.5mm [5.02"]
Ring Gear OD	213mm [8.4"]
Ring Gear Bolts	12 bolts on Ø152mm [5.98"]
Ring Gear Torque	96Nm [71 ft-lb]
Backlash	0.13-0.18mm [0.005-0.007"]
Bearing Cap Torque	85Nm [63 ft-lb]

Notes:

- 1 For replacement O-rings use only BS136 Viton 75.
- 2 Available only as complete 6 gear set # 728H111

ITEM #	QTY	DESCRIPTION	PART #	NOTES
01	2	SEAL HOUSING O-RING	160207	1
02	1	SEAL HOUSING ASSEMBLY	081807	
03	1	SHIM KIT	SHK004	
04	1	BONDED SEAL	160702	
05	1	CLUTCH GEAR	050806	
06	1	SPIDER BLOCK	070201	
07	1	LONG CROSS SHAFT	060204	
08	1	SIDE GEAR	SEE NOTE	2
09	2	COUNTERSUNK SCREWS	200213	
10	3	CROSS SHAFT RETAINING PIN	120601	
11	2	TAPERED ROLLER BEARING	NOT SUPPLIED	
12	1	FLANGE CAP ASSEMBLY	027313	
13	8	RETURN SPRING	150113	
14	1	SPLINED SIDE GEAR	SEE NOTE	2
15	2	SHORT CROSS SHAFT	060403	
16	4	PINION GEAR	SEE NOTE	2
17	4	PINION THRUST WASHER	151110	
18	2	SIDE GEAR THRUST WASHER	151010	
19	1	DIFFERENTIAL CASE	013013	
*	1	BULKHEAD FITTING KIT (O-RING TYPE)	170111	
*	1	PUSH-IN FITTING (5mm to 1/8" BSPP)	170201	
*	1	AIR LINE (5mm DIA X 6m LONG)	170301	
*	1	NIPPLE (1/8" to 1/8" BSPT)	170501	
*	1	SOLENOID VALVE (12V)	180103	
*	1	SWITCH	180209	
*	1	SWITCH COVER (REAR)	180211	
*	10	CABLE TIE	180301	
*	2	CABLE TIE (4.8 x 200mm)	180302	
*	1	WARNING LABEL	210101	
*	1	BUMPER STICKER	210102	
*	1	OPERATING & SERVICE MANUAL	210200	
*	1	INSTALLATION GUIDE	2102129	

* Not illustrated in exploded view.

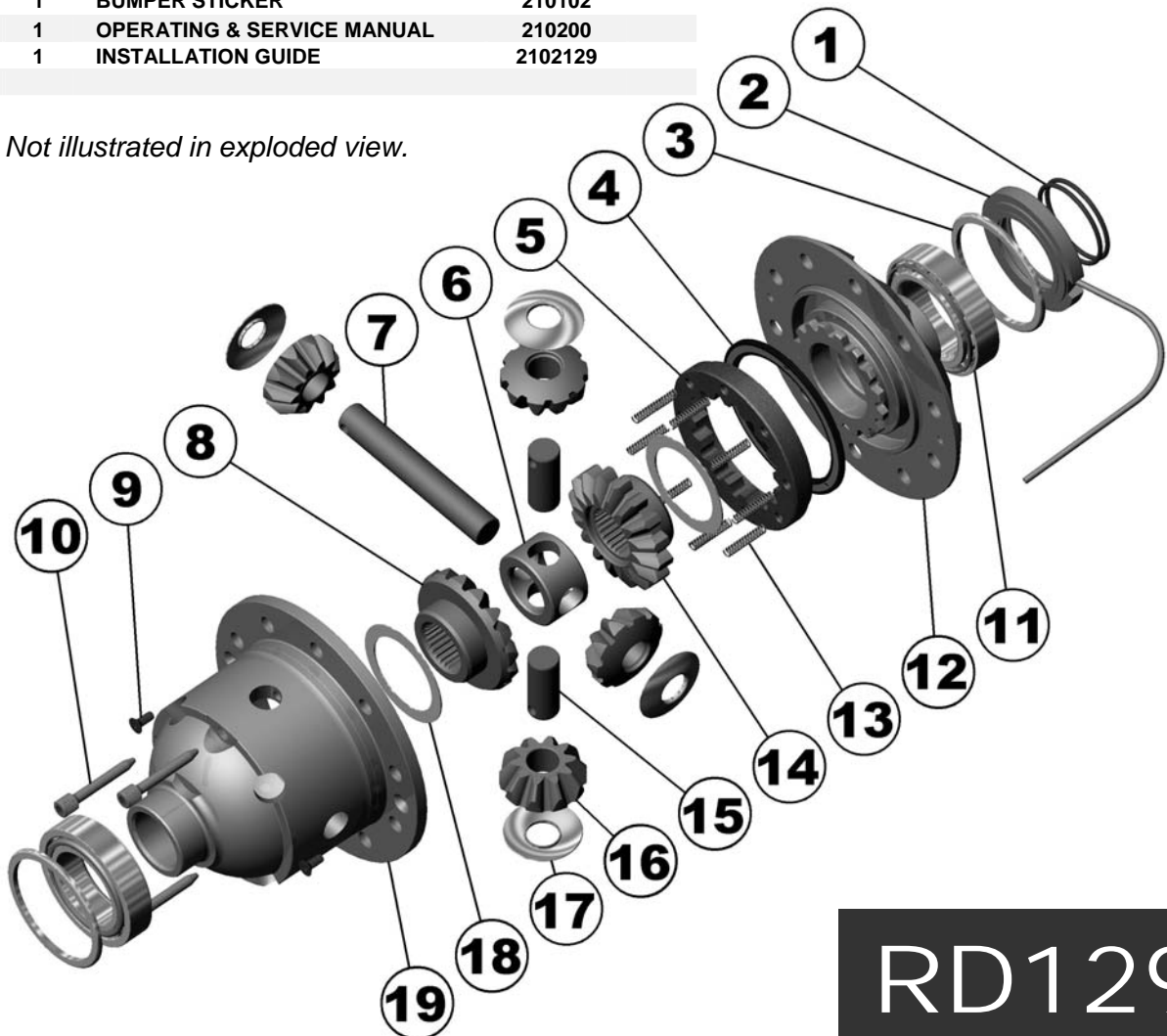

RD129

