

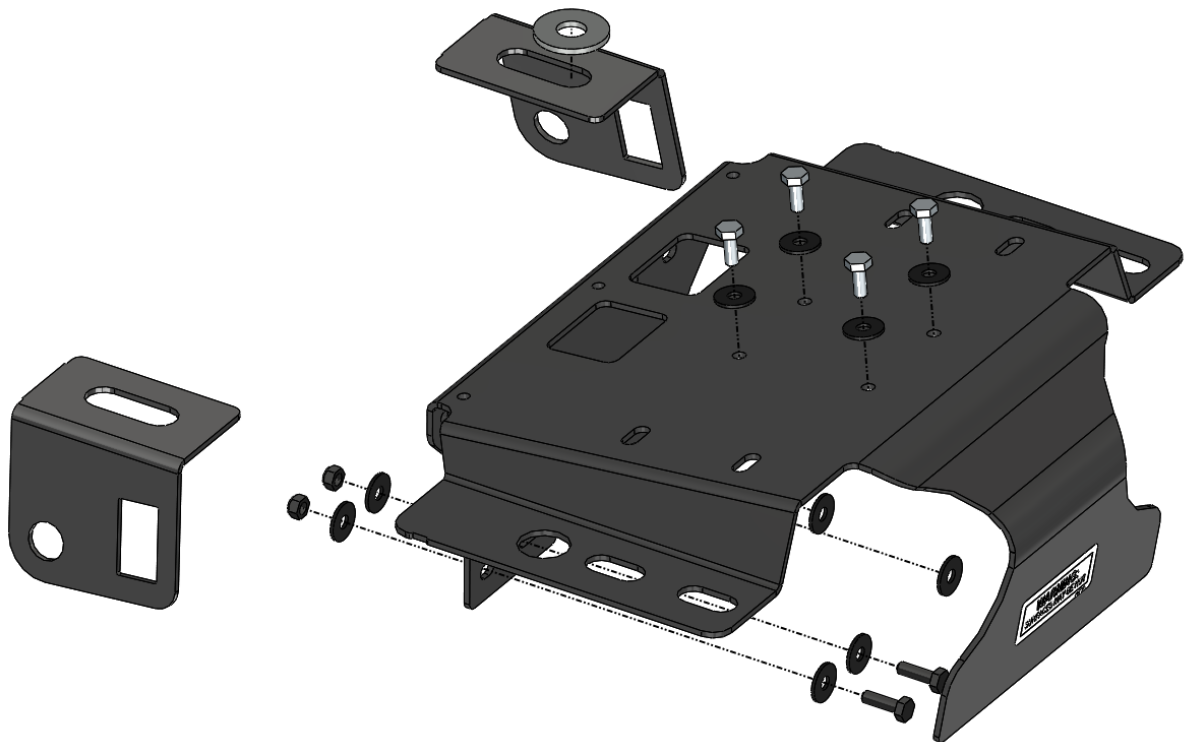

2007 ON JEEP COMPRESSOR BRACKET

INSTALLATION GUIDE

3550210



No liability is assumed for damages resulting in the use of the information contained herein.
ARB Air Locker Air Operated Locking Differentials, ARB Air Locker Air Activation System
and Air Locker are trademarks of ARB Corporation Limited.
Other product names used herein are for identification purposes only and may be trademarks of their
respective owners.

ARB 4x4 ACCESSORIES

Corporate Head Office

42-44 Garden St
Kilsyth, Victoria
AUSTRALIA
3137

Tel: +61 (3) 9761 6622
Fax: +61 (3) 9761 6807

Australian enquiries
North and South American enquiries
Other international enquiries

sales@arb.com.au
sales@arbusa.com
exports@arb.com.au

www.arb.com.au

Table of Contents:

1	Introduction	4
1.1	Pre-Installation Preparation	4
1.2	Description	4
1.3	Compatible Products	4
1.4	Kit Contents	5
1.5	Tool-Kit Recommendations	6
1.6	Vehicle Preparation (Seat removal)	7
2	Configuring the Compressor Bracket	10
2.1	Assembly of CKSA to Main Bracket	10
2.2	Assembling 4L Tank to Main Bracket (CKSA, LHS)	11
2.3	Configuring Optional LINX PRV with CKSA (LHS)	12
2.4	Assembly of CKMA to Main Bracket	14
2.5	Assembling 4L Tank to Main Bracket (CKMA, LHS)	15
2.6	Configuring Optional LINX PRV with CKMA (LHS)	16
2.7	Assembly of CKMTA to Main Bracket	18
2.8	Assembling 4L Tank to Main Bracket (CKMTA, LHS)	19
2.9a	Configuring Optional LINX PRV with CKMTA (LHS)	20
2.9b	Assembling Manifold Kit to Main Bracket (CKMTA option only, LHS)	22
3	Installing the Compressor Bracket Assembly (CKMTA Shown)	23
3.1	Installation of Compressor Bracket Assembly to Seat	23
3.2	Installation of Compressor Bracket Assembly & Seat to Vehicle	24
3.3	Post-Installation Check List	26

1 Introduction

IMPORTANT:

To assure the highest level of planning and reliability goes into this installation, please read this guide in its entirety before attempting any modifications to the vehicle.

1.1 Pre-Installation Preparation

Although your *ARB Air Compressor Bracket* comes complete with all the step by step instructions you will need to install it, ARB recommends that you have your ARB Air Compressor installed by a trained professional. Many ARB distributors around the world have been fully instructed in *Air Compressor* installations by ARB, and have gained a wealth of experience and skill from years of performing similar installations.

Not suited to “Tip and Slide” (a.k.a “Fold and Tumble”) type seats, seats with low front support bars and welded position sensor brackets on the inboard seat tracks.

TIP AND SLIDE SEAT



LOW SUP.TUBE & WELDED BRKT

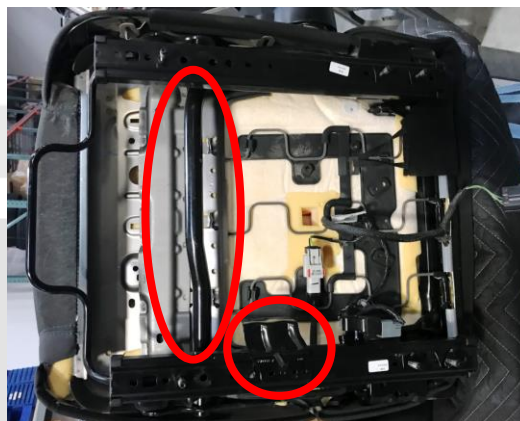

Make sure your *Air Compressor Bracket* kit is the correct model for your application and that it contains all of the parts listed in section 1.4 below. Also be sure you have appropriately equipped yourself with all the necessary tools, parts, materials and knowledge to complete this installation and minimize vehicle down time (see section 1.5 *Tool-Kit Recommendations*).

Please refer to your ARB Compressor and Air Locker Operating & Service Manuals for information on operating, servicing, driving technique, or trouble shooting your ARB Air Locker(s) if installed.

HINT: Place a ✓ mark inside each of the symbols as you complete each step. It is very important NOT to miss any of the steps!

1.2 Description

The Jeep Compressor Bracket enables the installation of a CKSA, CKMA or CKMTA with optional Air Locker Solenoids, 4L Air Tank, Push Lock, Switch, Manifold Kit (CKMTA only) and ARB LINX PRV under the passenger or driver’s seat of a Jeep Wrangler vehicle.

1.3 Compatible Products (Optional)

- 171601 | 4L Air Tank Kit
 - Note: (1x) 0740201 Hose Assy 300mm
 - (1x) 0740104 ELBOW JIC M-F
 - (1x) 0740105 Straight 1/8 BSPP-M to JIC4-M (Use 170631 for CKMTA)
- 180103 | Air Locker Control Solenoid (& 6mm Line, **included with Air Locker Kit**)
 - Note: Recommend (1x) 170217 Elbow Swivel Push-In 6mm x 1/8 BSPP



1 Introduction

- 180105 | Pressure Reg. Valve Hi-Flow (Used with **LINX** System to regulate air press.)
 - Note: (1x) 180902 Pressure Transducer 0-1 MPa, 5VDC
 - (2x) 0740105 Straight 1/8 BSPP-M to JIC4-M
 - (1x) 0740201 Hose Assy 300mm
 - (1x) 6177069 F/Kit Brkt Mount PRV-Solenoids
- 171503 | Manifold Kit (Inc. 2x 170631. Only required for CKMTA with no 4L Tank)
 - Note: (1x) 0740201 Hose Assy 300mm
 - (2x) 0740104 ELBOW JIC M-F
- 171403 | Assembly Female Push-Lock Coupling, JIC-4
 - Note: (1x) 0740201 Hose Assy 300mm
 - (1x) 0740104 ELBOW JIC M-F
- CKMTA Maximum Performance on-board (twin) Compressor
 - (1x) 170631 Adapter Straight JIC-4(M) to 1/4 NPT(M) (*Req. if no Manifold*)
- CKMA High Output on-board (single) Compressor
- CKSA Compact on-board (single) Compressor
- 180209 Compressor Switch (**Included with compressor**)

1.4 Kit Contents

- (1) 3750390 BRKT ASSY COMPRESSOR JEEP 07ON
- (1) 6177067 F/KIT 3550210 BRKT JEEP 07 ON, COMPRISING;
 - (1x RH, 1x LH) 3750346R/L BRKT MOUNT SWITCH RH/LH JEEP 07ON
 - (11x) 4581082 WASHER FLAT, M6x19x1.6 BZ
 - (1x) 4581288 WASHER FLAT, M10x35x3
 - (4x) 6151402 BOLT HX HD M6x1.0x16 BZ
 - (2x) 6151213 BOLT HX HD M6x1.0x20 BZ
 - (2x) 6151223 NUT NYLOC M6x1.0 BZ
 - (1x) 3789795 F/INST 3550210 BRKT JEEP 07 ON (*THIS DOCUMENT*)

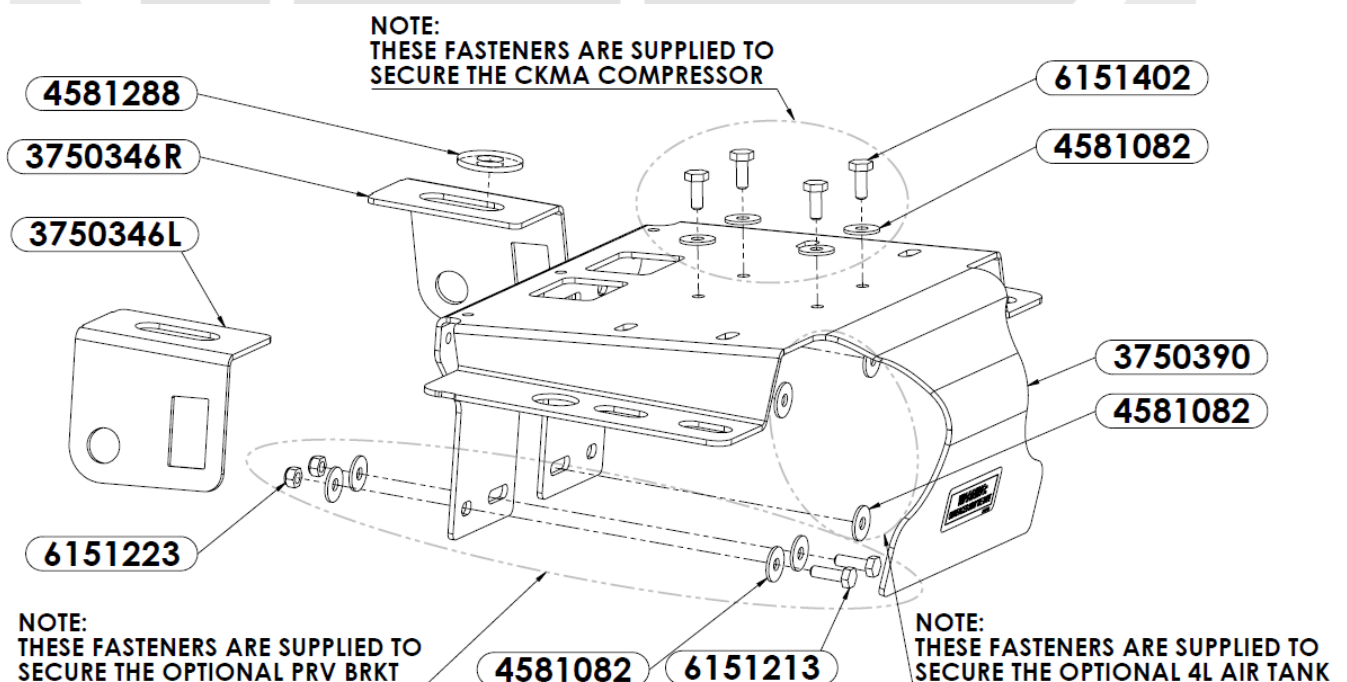

1 Introduction

1.5 Tool-Kit Recommendations

Below is a list of tools and supplies you may need to complete this installation.

1.5.1 Tools

- Standard automotive sizes of sockets including; 10mm,13mm,18mm
- Combination ring/open ratchet wrenches; 10mm x2 (for compressor mount screws/nuts), 12mm (for Air line Elbows if installed), 14mm x2 (for hose connections)
- Ratchet & short extension
- Breaker bar (to release 18mm seat/floor bolts)
- Alan keys; 3mm (CKSA), 4mm (CKMA & CKMTA), for adjusting compressor body mount.
- Power drill
- Metric drill set including Dia. 6mm drill bit
- Impact driver (optional)
- Screwdrivers; No.2 Phillips & Small flat
- Torx bits; T30 (to remove OE switch bracket from underside of seat riser) and T45 (to remove/re-install OE seat belt screws)
- Torque Wrench 5 to 100Nm range
- Long nose pliers.
- A razor knife to cut the carpet (if fitting Air Locker lines through the OE plug in the floor)
- A leak test gauge (i.e., ARB# ALTG01).
- A multimeter
- A soldering iron.

1.5.2 Supplies

- Thread lubricant/sealant compound for pressure fittings (e.g., LOCTITE #567 Teflon paste or plumbing supply Teflon tape)
- A soap and water mixture to test for air leaks.
- Electrical tape.
- Teflon Tape
- Solder and/or automotive crimp fittings.
- Silicon sealant (to seal area around Air Locker lines if installed)

1 Introduction

1.6 Vehicle Preparation

CAUTION: the air bag/seat sensor plugs (if present) will need to be disconnected prior to removing the seat. **DO NOT** activate the ignition after the seats have been removed, otherwise you may need to visit a dealer to reset the sensors in the seat.

A manufacturer's service manual and optional ARB operation & Installation manuals should be used in conjunction with these instructions.

1.6.1 Seat Removal (JK JEEP 2007 Model Shown)

- To remove the Passenger or Driver seat, remove the (4x) OE screws securing the seat to the floor using an 18mm socket, breaker bar and ratchet. Retain all screws for later.



- Slide and tilt the seat fully forward to aid removal through front door.



- Unplug any cables attached to the seat. The number and type of plugs will be model and year dependent. (JK JEEP 2007 RH Drivers Side Shown)



1 Introduction

- Remove the screw securing the seat belt to the side of the seat using a T45 Torx bit. Retain for later re-use



- Carefully remove the head rest from the seat, and the seat from the vehicle and place on a clean work surface, taking care to keep the sliding seat tracks in their original aligned positions. **HINT:** Release the door strap from its post to enable a wider door opening if required, prior to seat removal (Don't forget to reconnect it later).

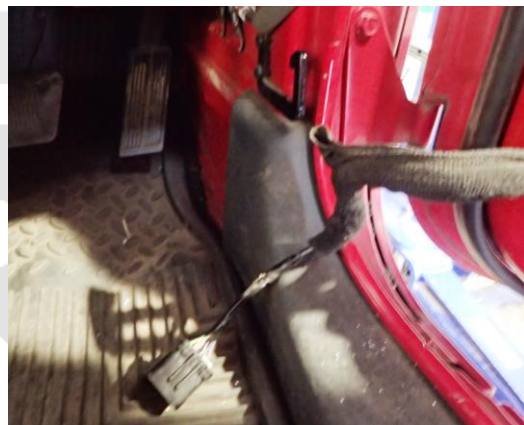

- Recline the seat all the way backwards, then place onto the floor with the sitting area facing downwards.

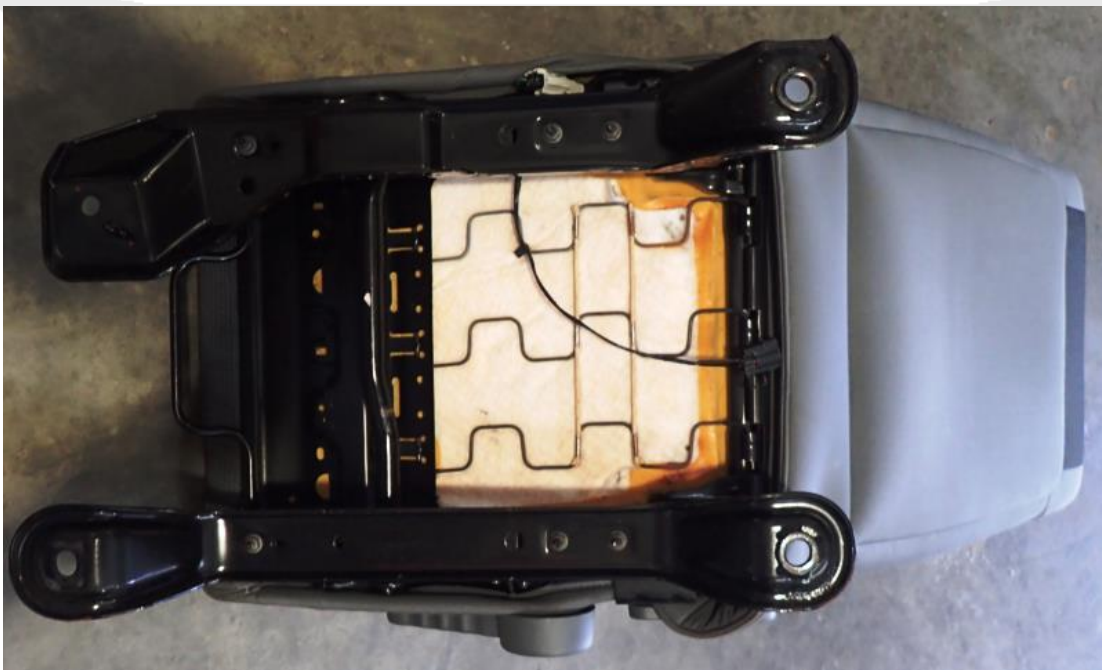

1 Introduction

- Remove and retain the (6x) OE M8 Hex Flange Lock Nuts securing the (2x) seat risers to the M8 studs in the seat tracks using a 13mm socket and ratchet. Remove the seat risers and place at either side for later fitment. (JK JEEP 2007 RH Drivers Side Shown)

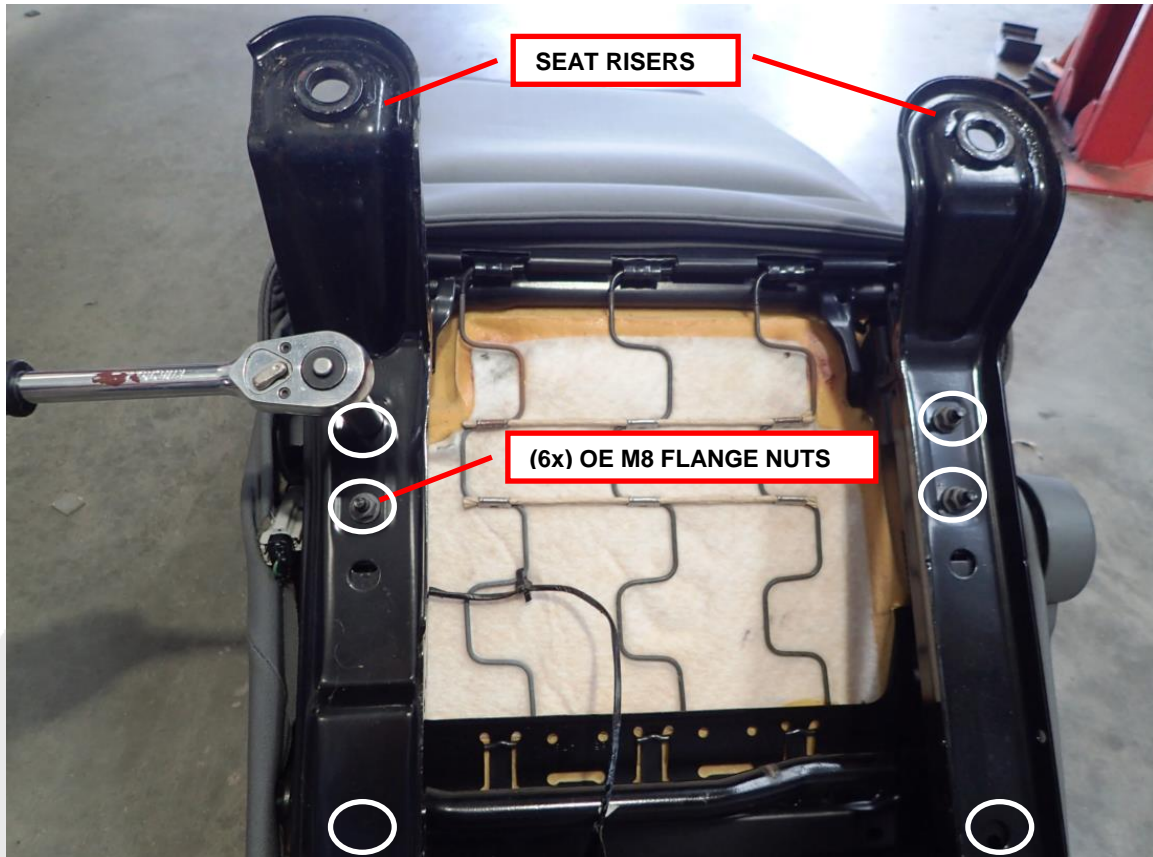

- If installed, disconnect the factory wire harness with pliers and then the OE bracket securing the wire harness to the seat riser with a T30 Torx bit and driver. Discard the OE bracket and T30 Torx screws. Loosely zip tie the harness to the seat as shown. (JK JEEP 2016 LH Drivers Side Shown)

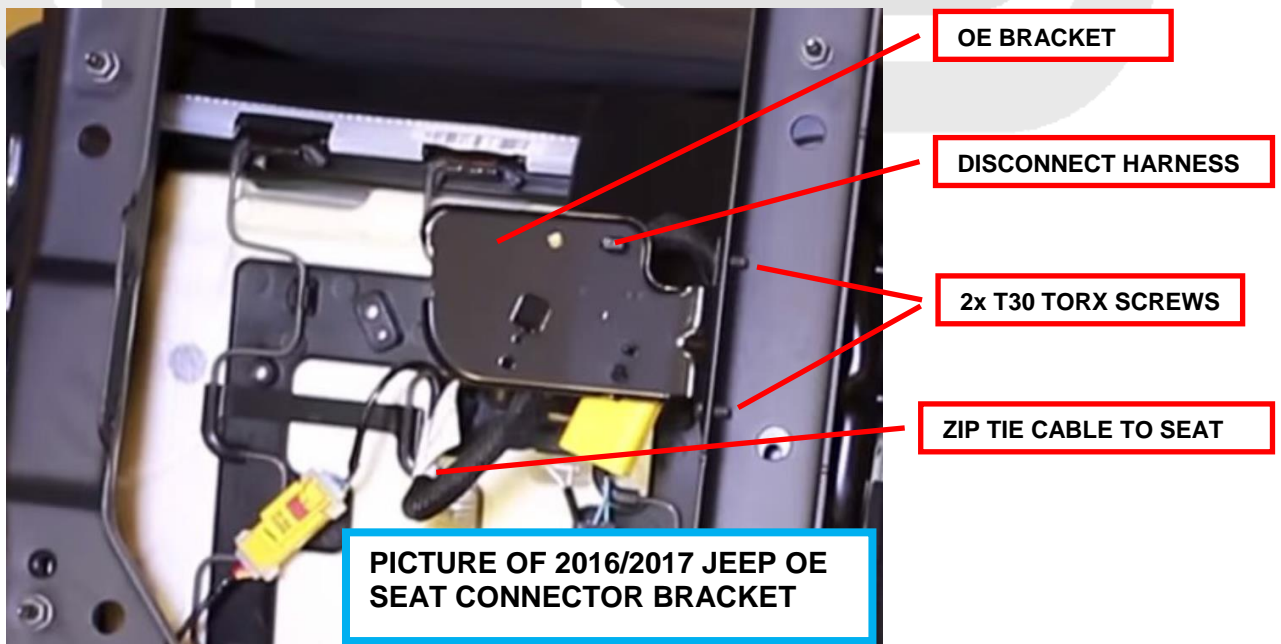

2 Configuring the Compressor Bracket

2.1 Assembly of CKSA to Main Bracket

IMPORTANT:

This step applies to installation of a CKSA Single Compressor with optional accessories.

- Install the fittings as shown. The 1/8 BSPT plug and Pressure Switch are included in the CKSA Kit
- Use a 3mm Alan key to remove and reverse the (2x) M4 cap screws and nuts on the compressor motor housing. (Refer to the CKSA manual for adjustment and wiring of the compressor)
- Use the M6 fasteners supplied with the CKSA to connect it to the main bracket. **Torque to 3.5Nm**
- Rotate the motor housing as shown then secure the (2x) M4 cap screws. **Torque to 3.5Nm**

NOTE : Take care to seal all fittings.

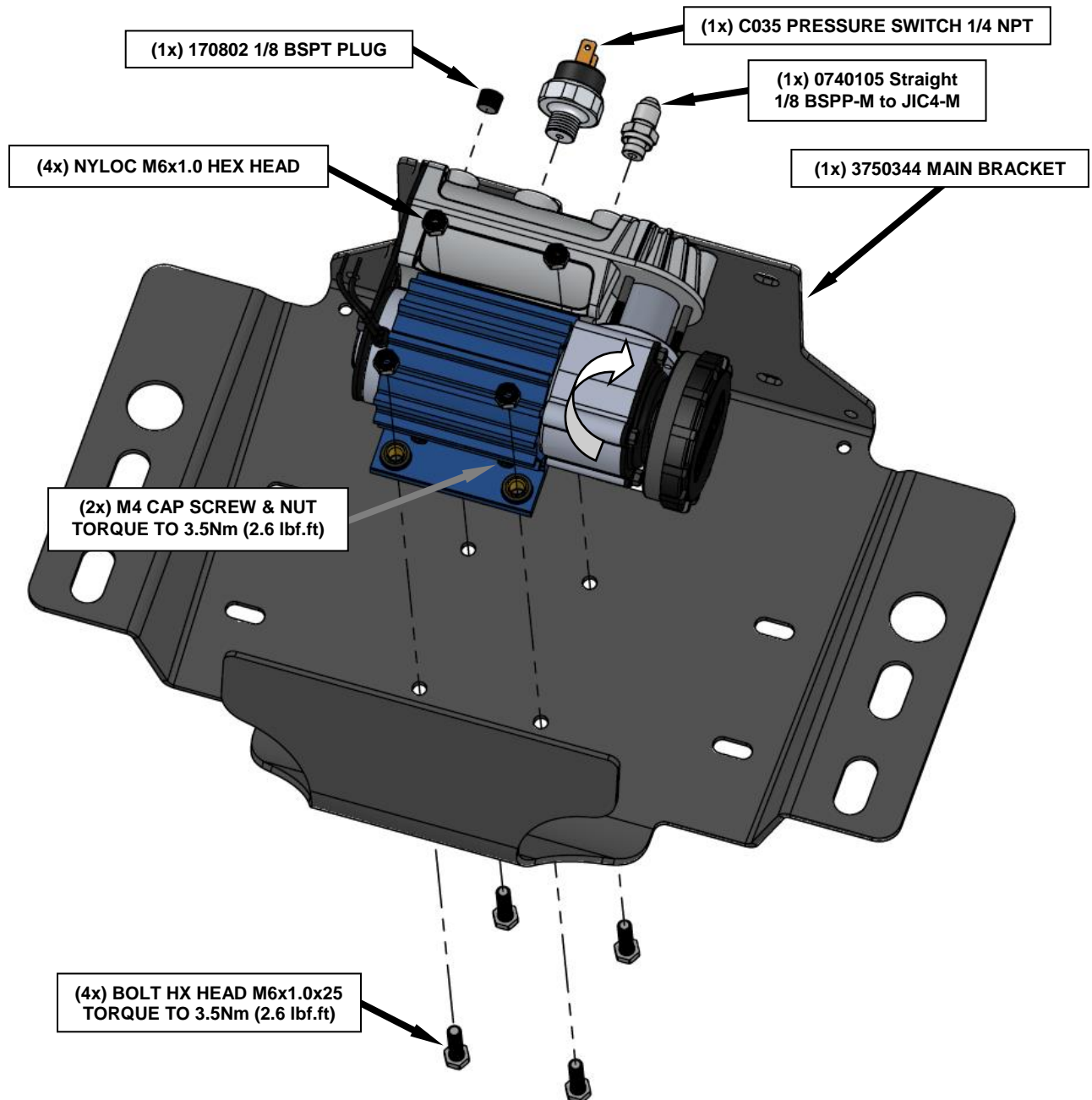

2 Configuring the Compressor Bracket

2.2 Assembling 4L Tank to Main Bracket (CKSA, LHS shown)

- Secure the optional 4L Air Tank to the main bracket using (3x) M6x16 bolts from the Tank Kit as shown below. Discard the M6 spring washers that come with the kit and use the M6 flat washers provided. **Torque to 9Nm (7 lbf.ft)**
- Connect the CKSA (output) to the 4L Tank (input) using the optional 300mm hose and elbow as shown.

NOTE :

Compressors are not supplied with this kit. Solenoids are included in the ARB Air Locker Kits. Please refer to the list of Compatible Products above or your nearest ARB Supplier for further details.

CKSA Single Compressor & 4L Tank

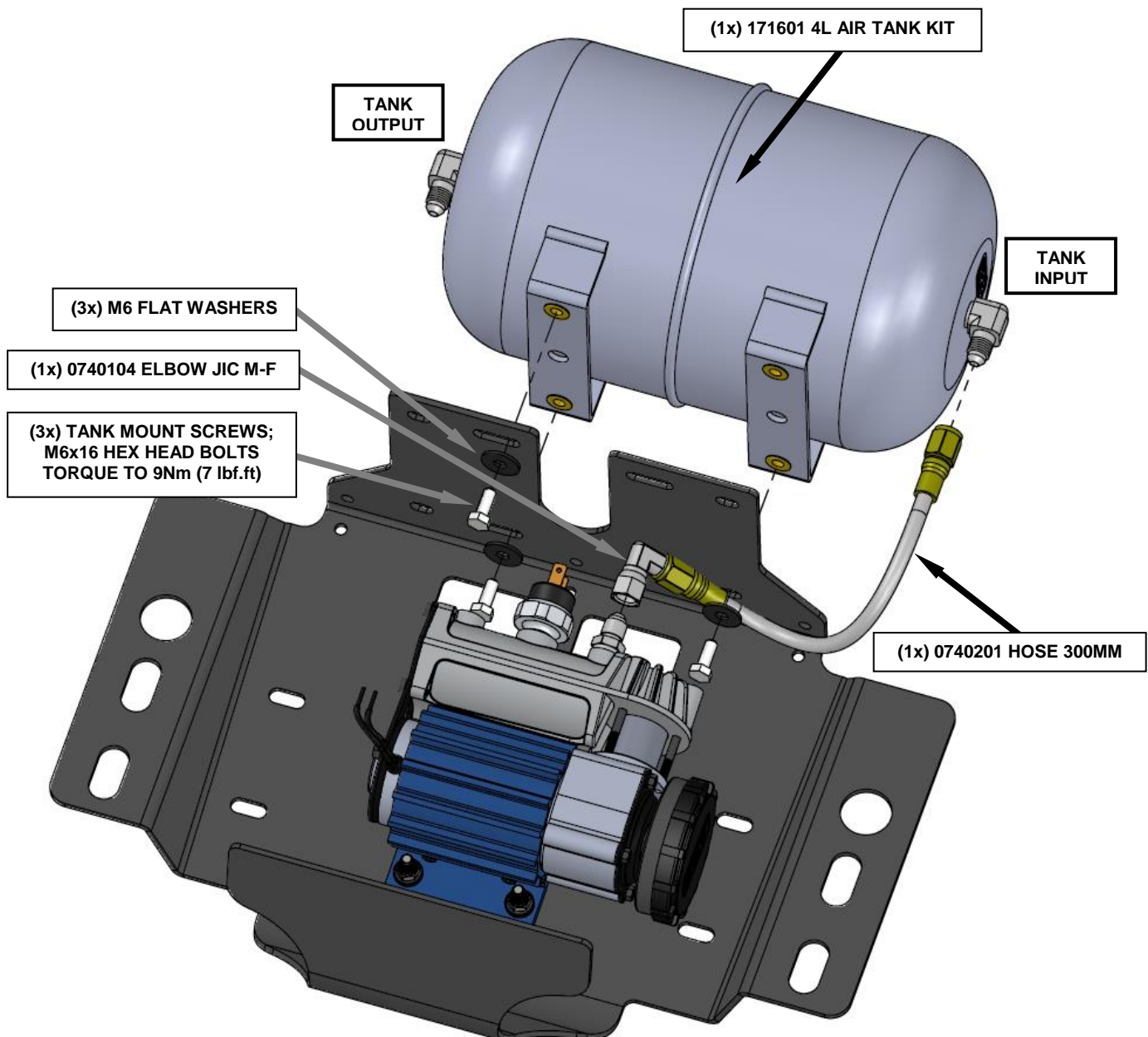

2 Configuring the Compressor Bracket

2.3 Configuring optional LINX PRV with CKSA (LHS shown)

- ☐ Configure the optional LINX PRV, Compressor Switch, Push lock fitting and 6mm Solenoids daisy-chained, as shown below.

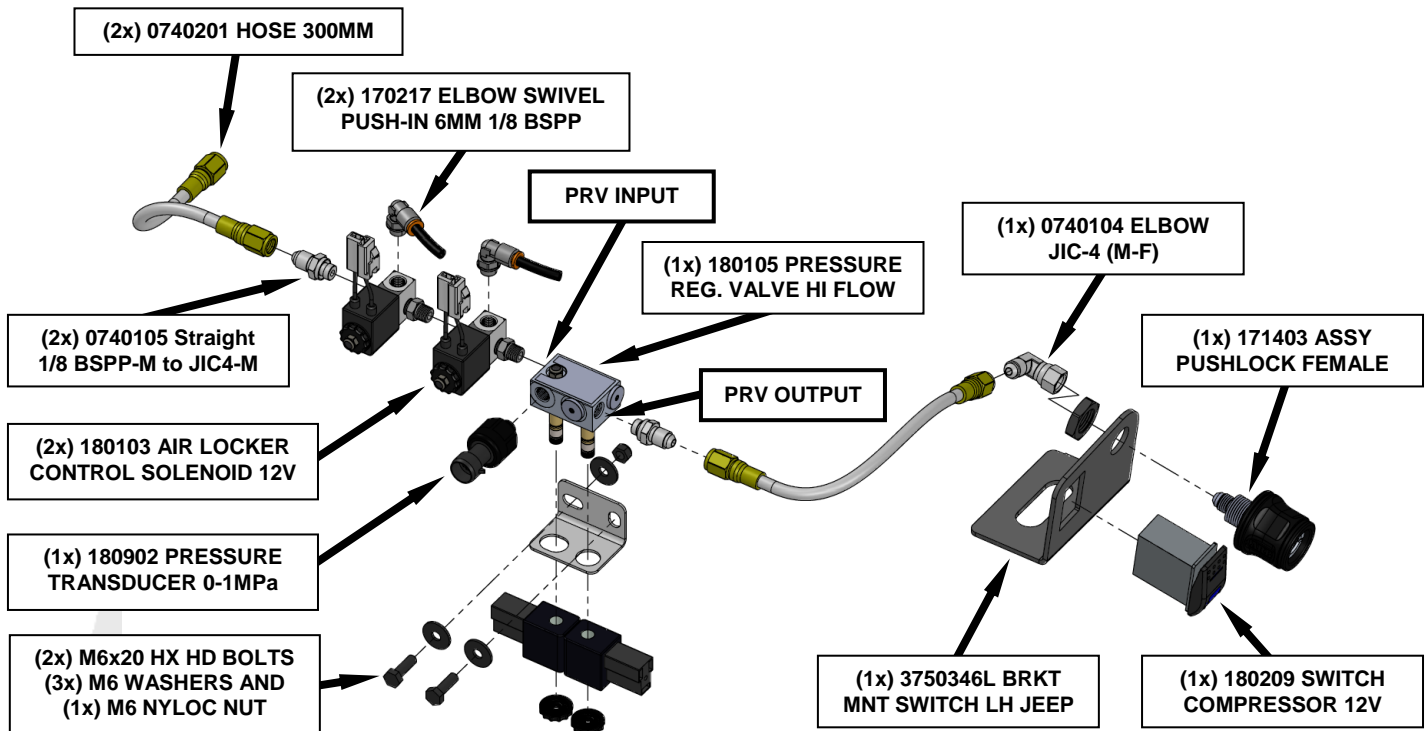

- ☐ Secure the configured LINX PRV assembly to the Main Bracket and 4L Tank using (2x) M6x20 hex head bolts, (3x) M6 flat washers and (1x) M6 Nyloc nut provided as shown below.
- ☐ Connect the 4L Tank (output) to the PRV (input) using the optional 300mm hose and straight adaptor fitted to the last daisy-chained 6mm Solenoid, as shown.

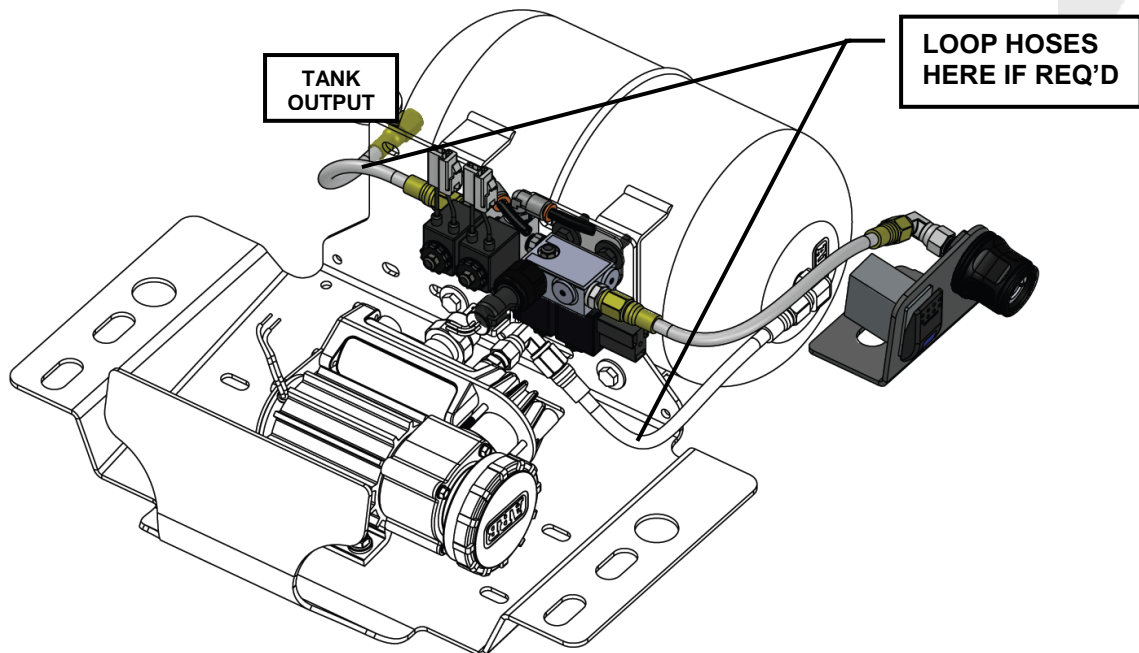

2 Configuring the Compressor Bracket

☐ Completed assembly of **CKSA Single Compressor** with optional 4L Tank, Compressor Switch, Push lock fitting, PRV and 2x daisy-chained 6mm Air Locker Solenoids is shown below.

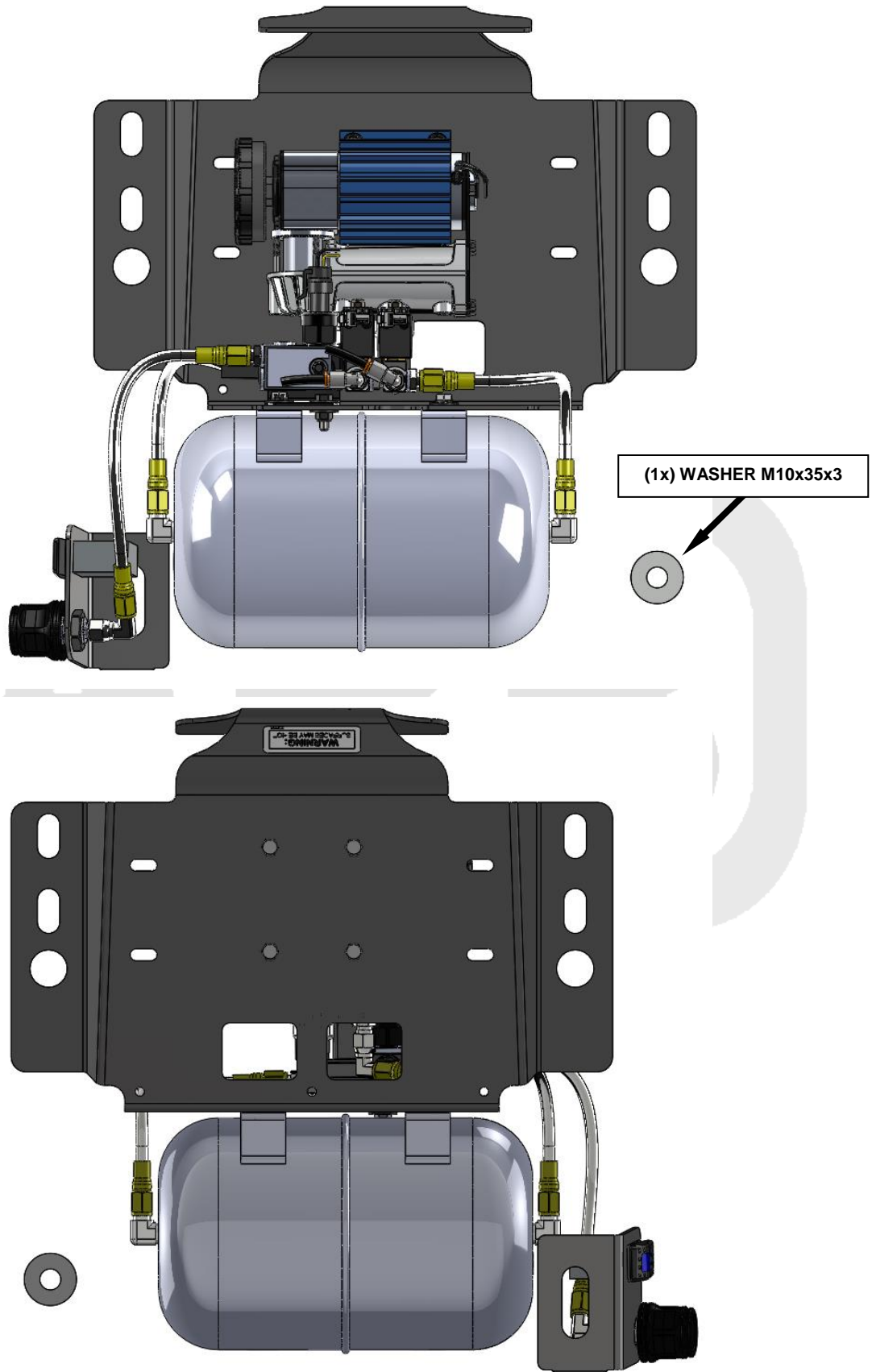

2 Configuring the Compressor Bracket

2.4 Assembly of CKMA to Main Bracket

IMPORTANT:

This step applies to installation of a CKMA Single Compressor with optional accessories.

- Install the fittings as shown. The 1/8 BSPT plug and Pressure Switch are included in the CKMA Kit
- Use a 4mm Alan key to loosen the (2x) M5 cap screws and nuts on the compressor motor housing. (Refer to the CKMA manual for adjustment and wiring of the compressor)
- Use the M6 fasteners supplied with this Kit to connect it to the main bracket. **Torque to 9Nm**
- Rotate the motor housing as shown then secure the (2x) M5 cap screws. **Torque to 6Nm**

NOTE : Take care to seal all fittings.

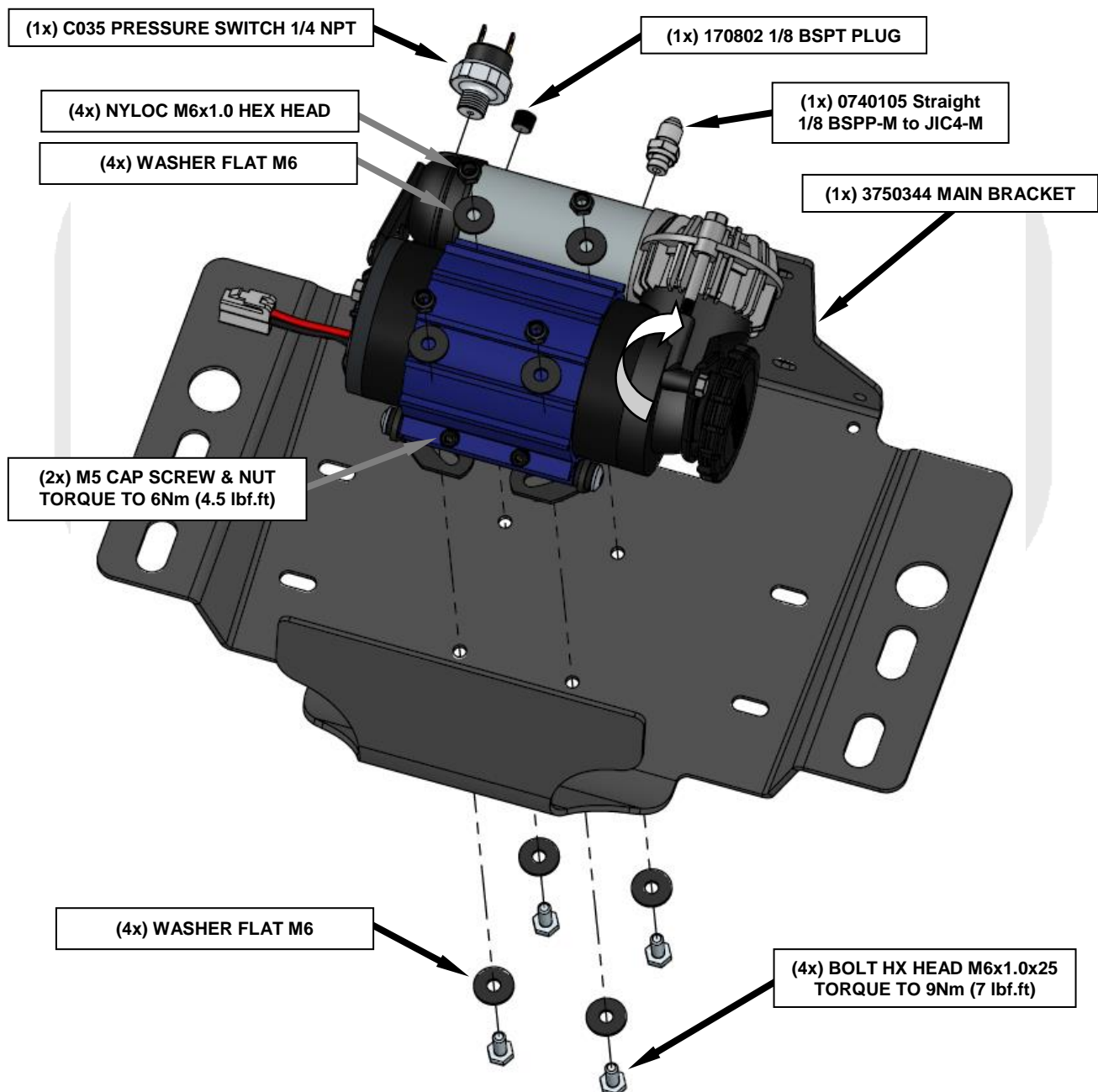

2 Configuring the Compressor Bracket

2.5 Assembling 4L Tank to Main Bracket (CKMA, LHS shown)

- Secure the optional 4L Air Tank to the main bracket using (3x) M6x16 bolts from the Tank Kit as shown below. Discard the M6 spring washers that come with the kit and use the M6 flat washers provided. **Torque to 9Nm (7 lbf.ft)**
- Connect the CKMA (output) to the 4L Tank (input) using the optional 300mm hose and elbow as shown.

NOTE :

Compressors are not supplied with this kit. Solenoids are included in the ARB Air Locker Kits. Please refer to the list of Compatible Products above or your nearest ARB Supplier for further details.

CKMA Single Compressor & 4L Tank

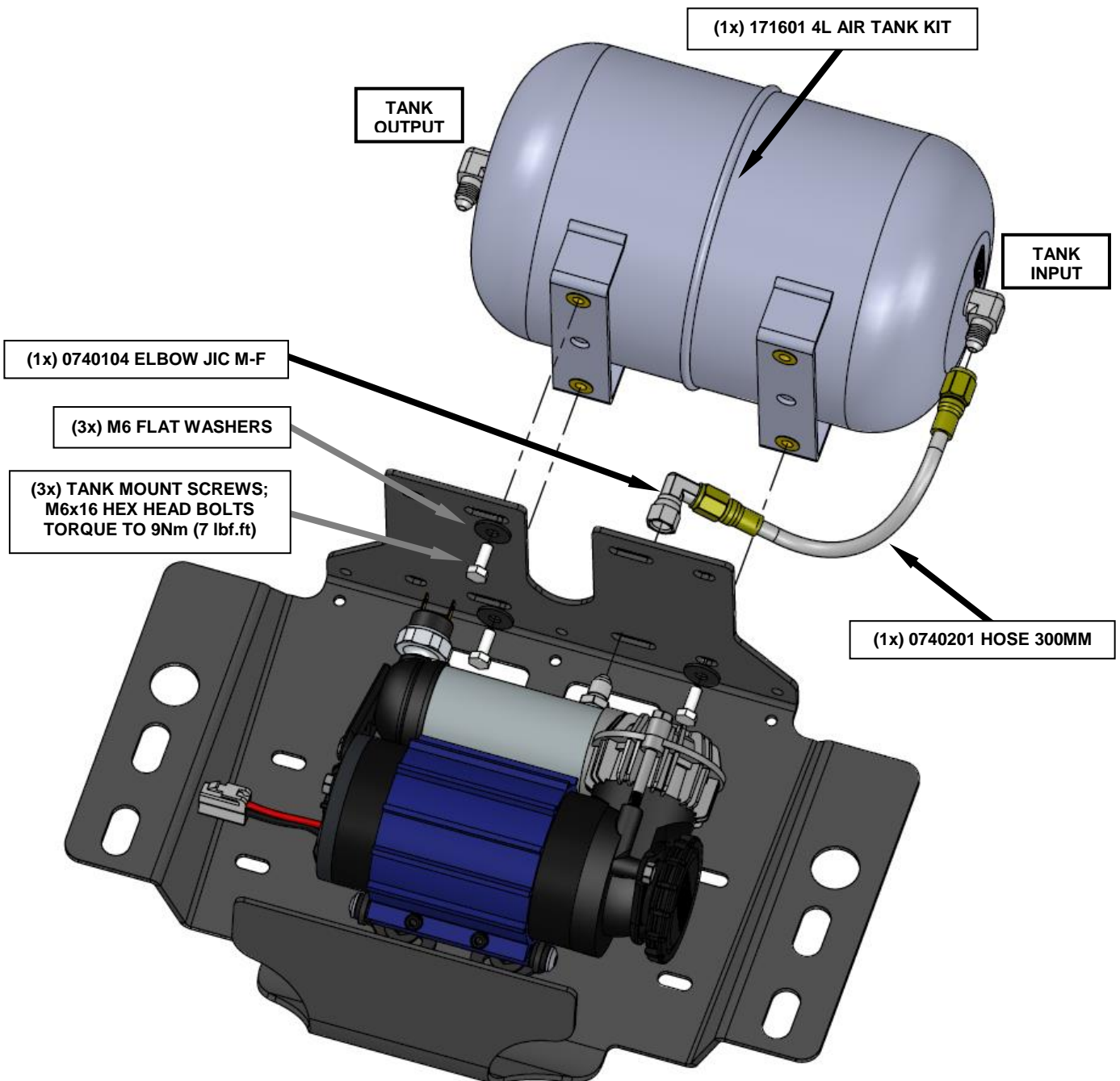

2 Configuring the Compressor Bracket

2.6 Configuring optional LINX PRV with CKMA (LHS shown)

- Refer to Section 2.3 for PRV configuration details.
- Secure the configured LINX PRV assembly to the Main Bracket and 4L Tank using (2x) M6x20 hex head bolts, (3x) M6 flat washers and (1x) M6 Nyloc nut provided as shown below.
- Connect the 4L Tank (output) to the PRV (input) using the optional 300mm hose and straight adaptor fitted to the last daisy-chained 6mm Solenoid, as shown.

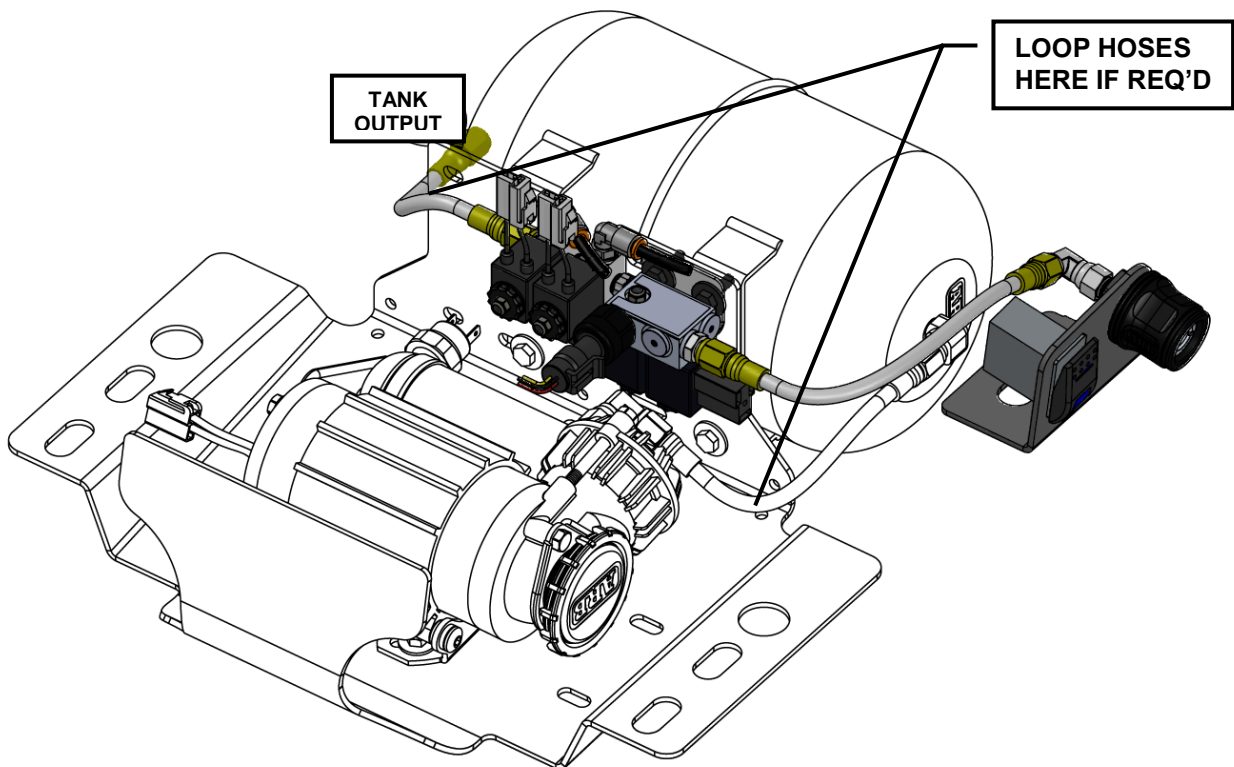

2 Configuring the Compressor Bracket

☐ Completed assembly of **CKMA Single Compressor** with optional 4L Tank, Compressor Switch, Push lock fitting, PRV and 2x daisy-chained 6mm Air Locker Solenoids is shown below.

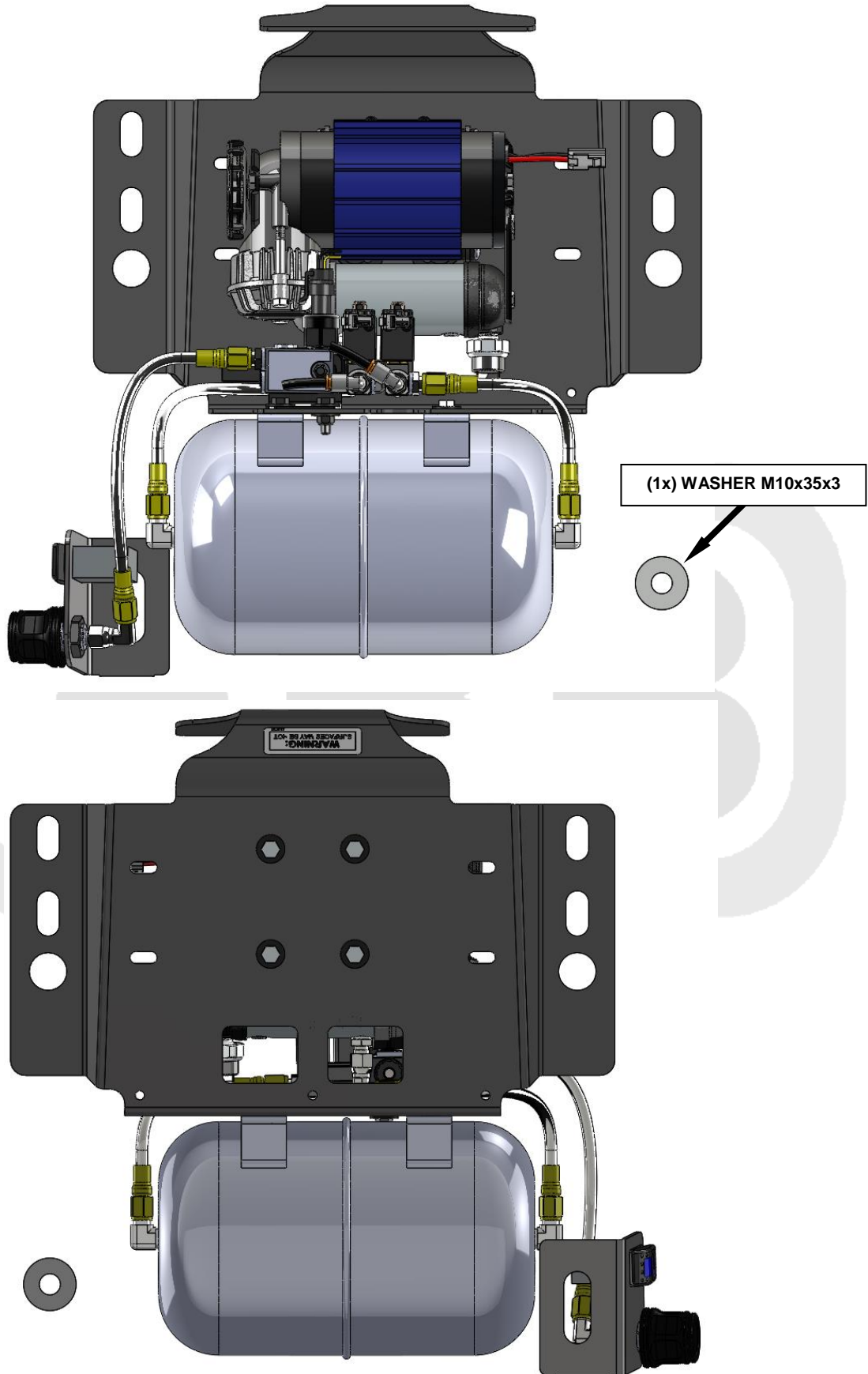

2 Configuring the Compressor Bracket

2.7 Assembly of CKMTA to Main Bracket

IMPORTANT:

This step applies to installation of a CKMTA Twin Compressor with optional accessories.

- Install (1x) 170631 Adaptor JIC-4(M) to 1/4 NPT (M) as shown.
- Remove the CKMTA cover, loosen M6 manifold bolt using a 10mm socket, rotate as shown, tighten manifold bolt **Torque to 9Nm** and replace the cover. (Refer to the CKMTA manual for adjustment and wiring of the compressor)
- Use the M6 fasteners supplied with the CKMTA Kit to connect it to the main bracket. **Torque to 9Nm**

NOTE : Take care to seal all fittings.

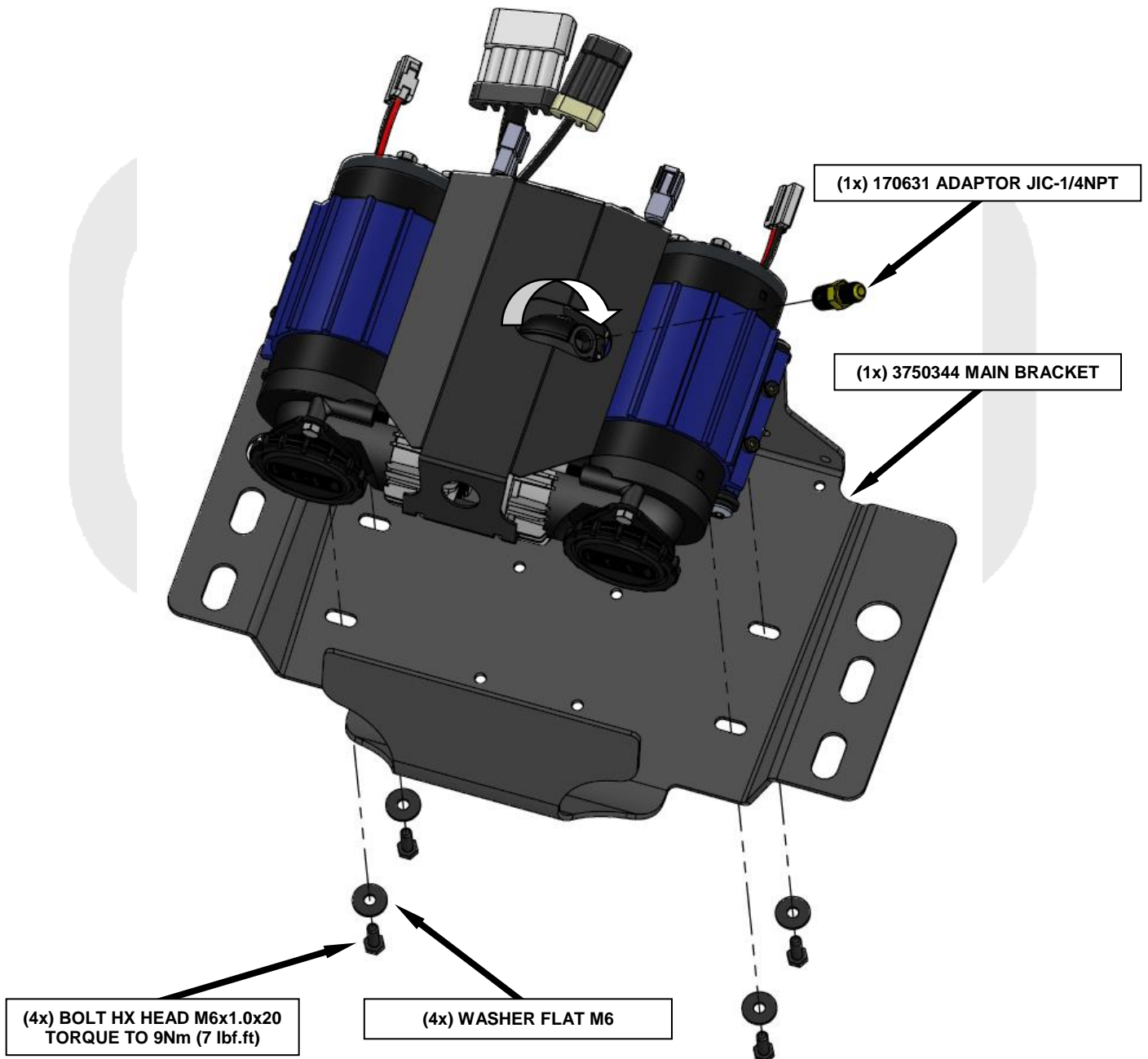

2 Configuring the Compressor Bracket

2.8 Assembling 4L Tank to Main Bracket (CKMTA, LHS shown)

- Secure the optional 4L Air Tank to the main bracket using (3x) M6x16 bolts from the Tank Kit as shown below. Discard the M6 spring washers that come with the kit and use the M6 flat washers provided. **Torque to 9Nm (7 lbf.ft)**
- Connect the CKMTA (output) to the 4L Tank (input) using the optional 300mm hose and elbow as shown.

NOTE :

Compressors are not supplied with this kit. Solenoids are included in the ARB Air Locker Kits. Please refer to the list of Compatible Products above or your nearest ARB Supplier for further details.

CKMTA Twin Compressor & 4L Tank

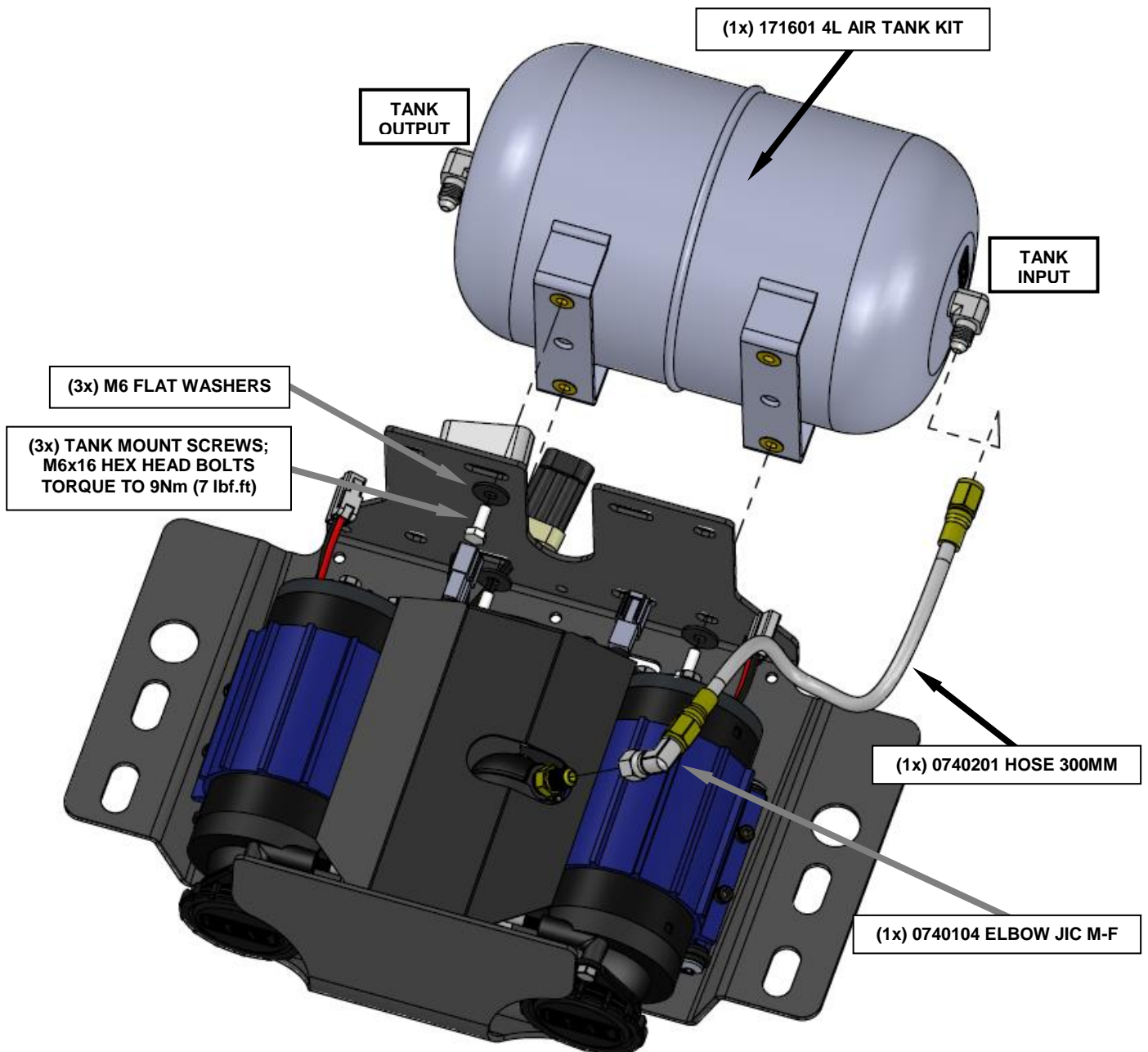

2 Configuring the Compressor Bracket

2.9a Configuring optional LINX PRV with CKMTA (LHS shown)

- Refer to Section 2.3 for PRV configuration details.
- Secure the configured LINX PRV assembly to the Main Bracket and 4L Tank using (2x) M6x20 hex head bolts, (3x) M6 flat washers and (1x) M6 Nyloc nut provided as shown below.
- Connect the 4L Tank (output) to the PRV (input) using the optional 300mm hose and straight adaptor fitted to the last daisy-chained 6mm Solenoid, as shown.

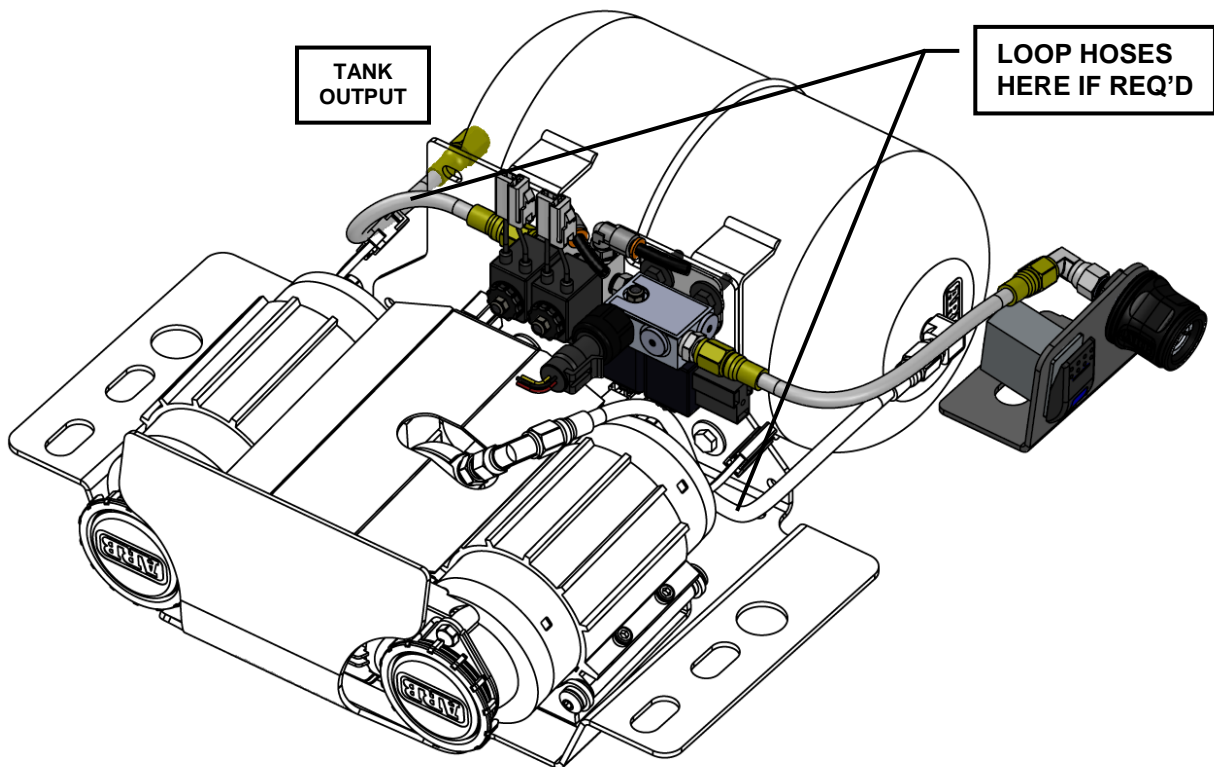

2 Configuring the Compressor Bracket

□ Completed assembly of **CKMTA Twin Compressor** with optional 4L Tank, Compressor Switch, Push lock fitting, PRV and 2x daisy-chained 6mm Air Locker Solenoids is shown below.

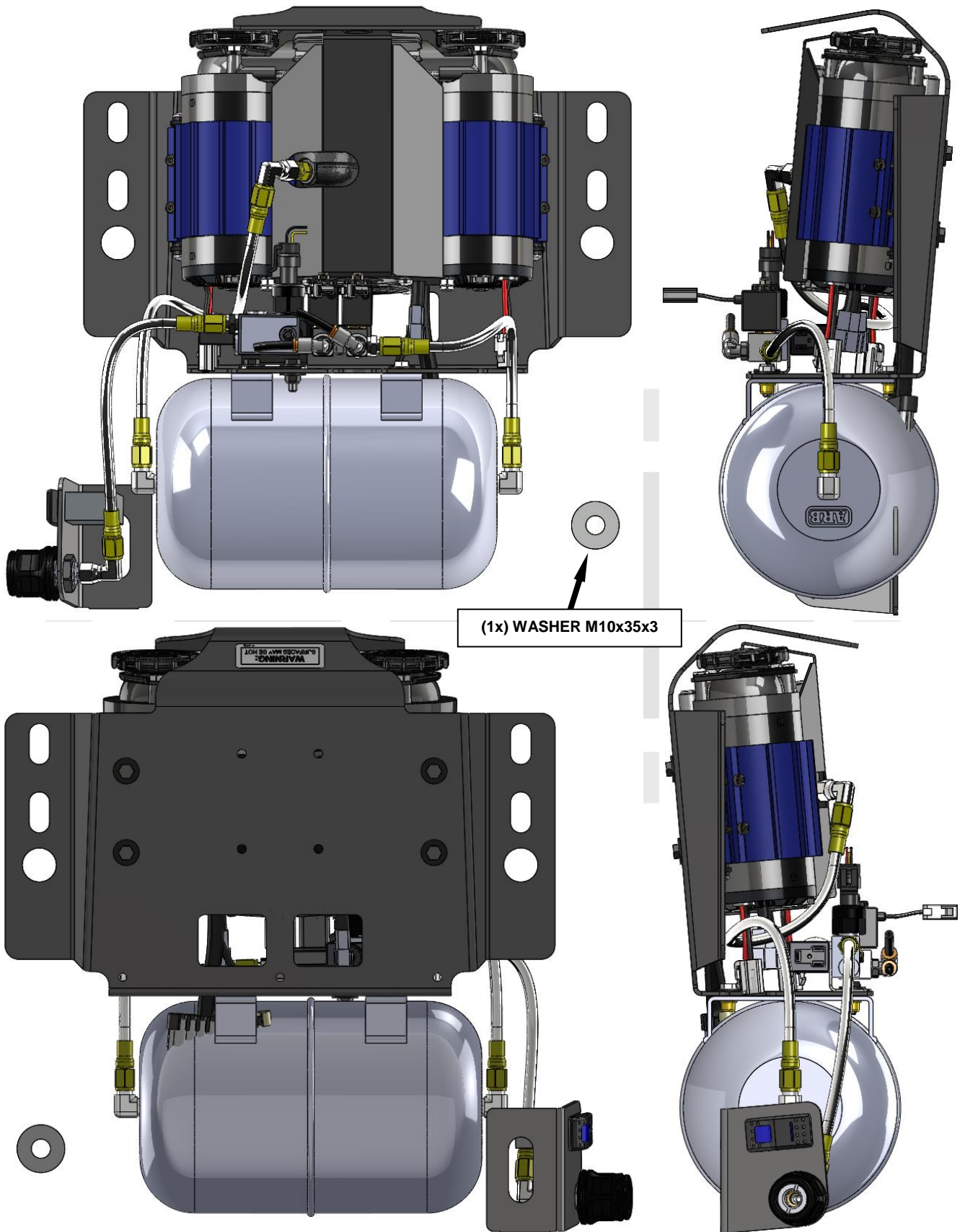

2 Configuring the Compressor Bracket

2.9b Assembling Manifold Kit to Main Bracket (CKMTA Option only, LHS shown)

- Install the **CKMTA** Compressor as per Step 2.7
- If applicable, install the optional Manifold Kit to the Main Bracket as shown using the M6 fasteners supplied. **Torque to 9Nm (7 lbf.ft)** (NB: 2x optional 6mm Solenoids shown on manifold)
- Refer to the CKMTA & Air Locker Manifold Installation Guides to install the manifold and braided hoses at the position shown. Ensure the connections are sealed effectively.

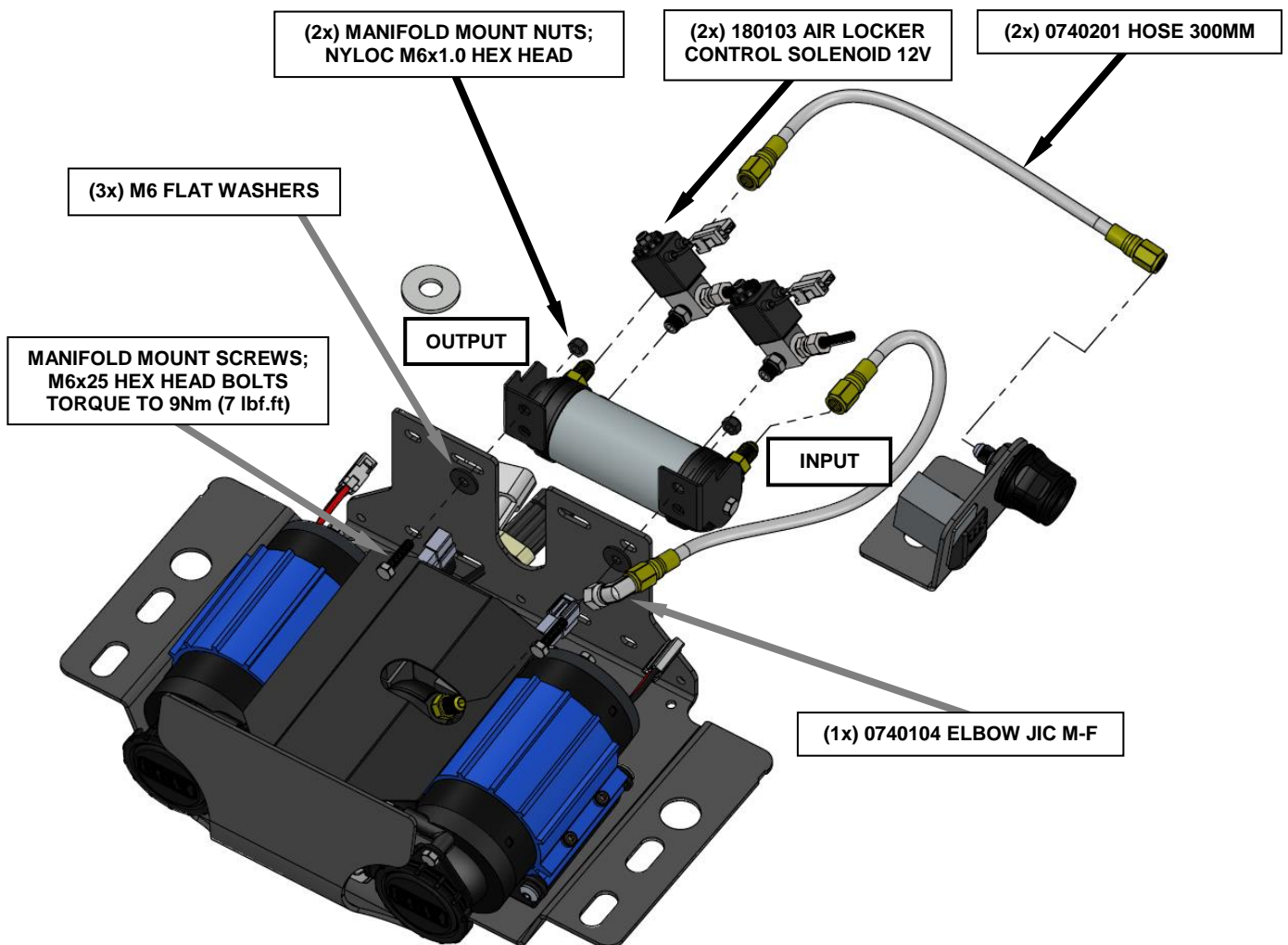

3 Installing the Compressor Bracket Assembly

3.1 Installation of Compressor Bracket Assembly to Seat (CKMTA, RHS shown)

- Ensure that all cables and connections are clear of mating surfaces, the seat tracks are aligned correctly, then place (1x) 4581288 M10 Flat Washer over the front inboard M8 stud as shown. Locate the Compressor Bracket assembly over the (4x) M8 OE studs to the rear of the seat and place (1x) 3750346R/L Switch Bracket over the front outboard M8 stud, then re-fit the seat risers to either side as shown, securing them to the seat with (6x) OE M8 Hex Flange Lock Nuts removed earlier using a 13mm socket and torque wrench. **Torque to Factory Specification**
- If installed, secure the ground wire from the LINX PRV harness under one of the OE M8 studs as shown, using an M8 washer to protect the crimped eyelet from rotating under torque. (Refer to the ARB LINX Manual for further configuration and wiring options)
- Re-attach the OE seat connector/cable to the slot/hole set located in the seat riser as shown.

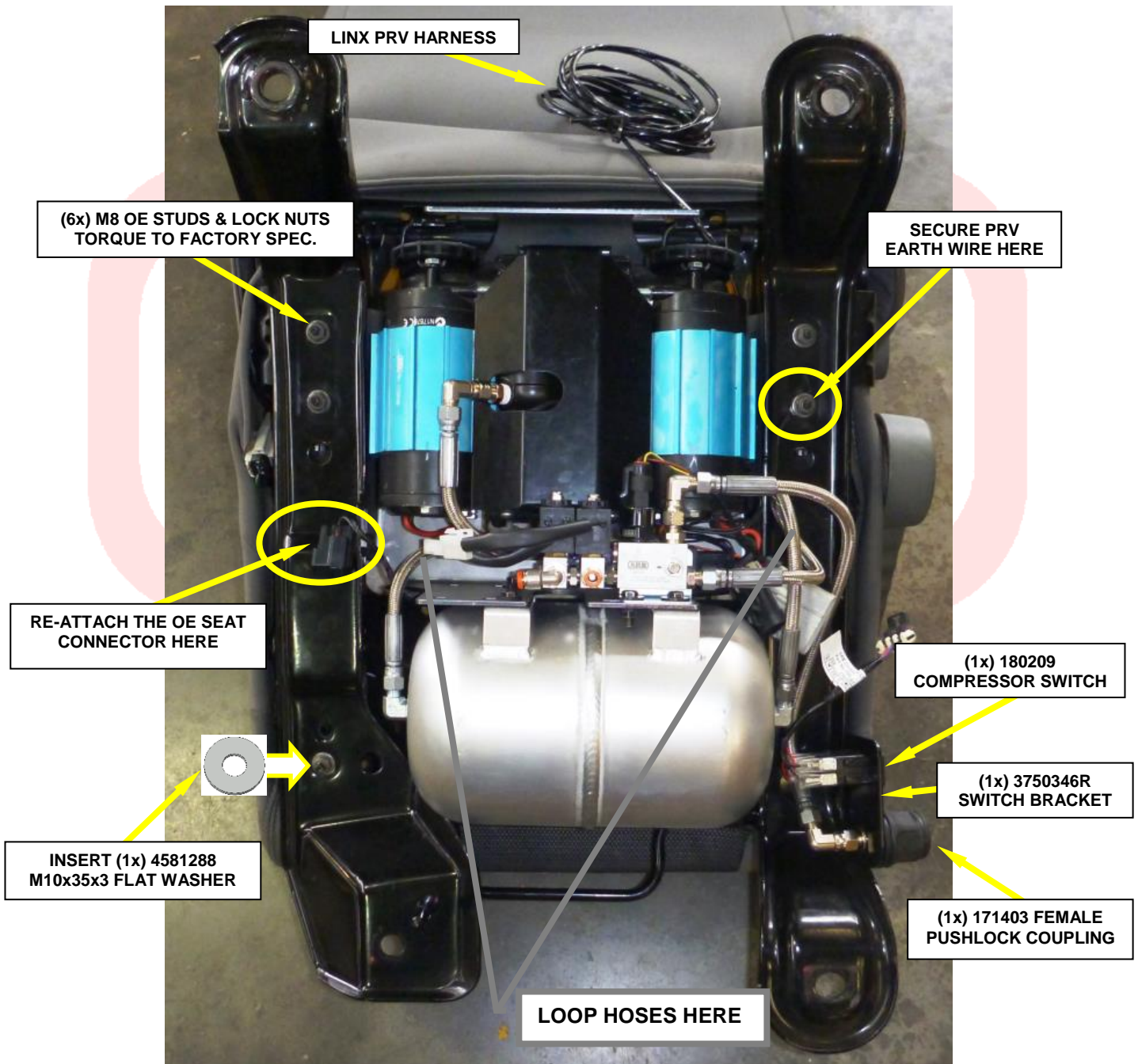

3 Installing the Compressor Bracket Assembly

3.2 Installation of Compressor Bracket Assembly & Seat to Vehicle

- With the assistance of a second person, carefully lift and position the seat and compressor assembly into the vehicle, locating it in a way to give access for re-connecting the OE seat cable/connectors to the vehicle harness prior to securing the seat to the floor.

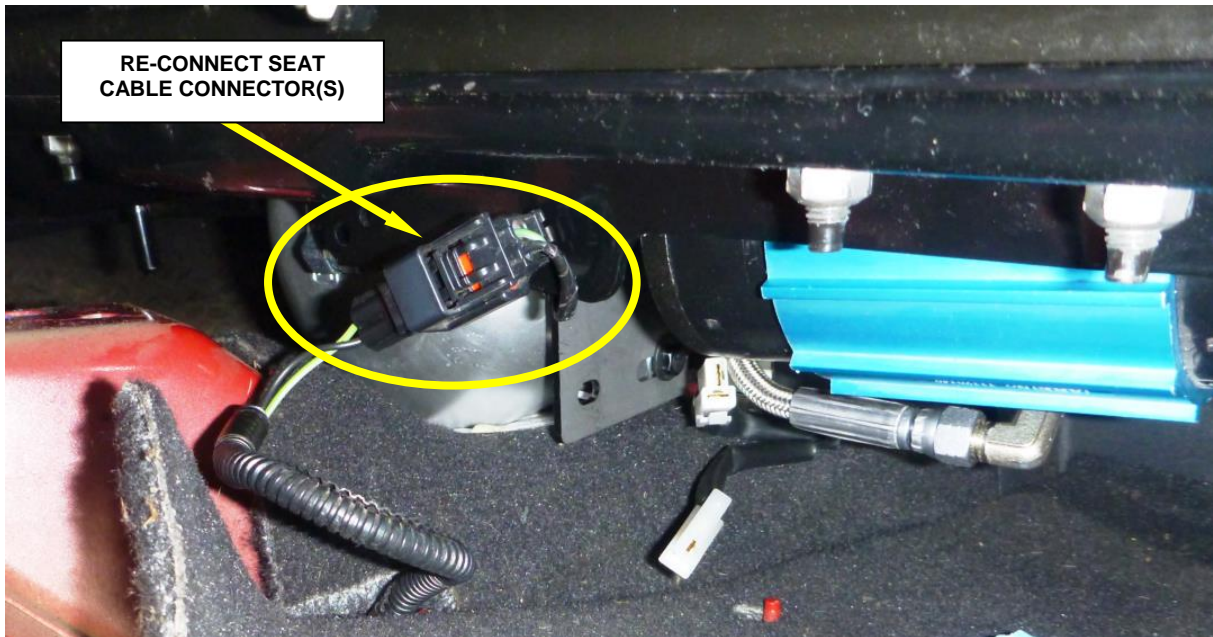

- Align the seat risers over the floor mount points, then secure with the (4x) OE M12 screws removed earlier using an 18mm socket and torque wrench. **Torque to Factory Specification**

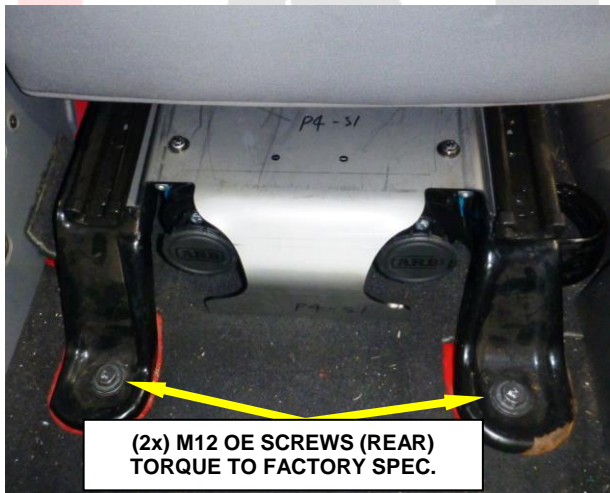

- Re-attach the OE screw securing the seat belt to the side of the seat using a T45 Torx bit. **Torque to Factory Specification**



3 Installing the Compressor Bracket Assembly

- Re-fit the head rest if removed earlier.
- Re-fit the door strap & connector if removed earlier.



- Refer to the various ARB Compressors, Air Locker, ARB LINX and Vehicle service manuals to route and connect the specific compressor configuration to the vehicles battery/connections.



3 Installing the Compressor Bracket Assembly

3.3 Post-Installation Check List

Now that the compressor installation has been completed, ARB recommends that you take the time to complete the following check list just to insure that you haven't missed any of the vital steps.

- The air system has been leak tested.
- The air filter position will not be exposed to moisture, dust or dirt.
- All air lines and wiring have been securely cable tied to resist snagging.
- Switch(es) have been securely mounted within operator reach, yet well away from danger of accidental engagement.
- Switch(es) function properly and illuminate to indicate activation.

For warranty and service purposes, please fill in the following fields and supply a copy to the customer (if applicable).

ARB PRODUCT MODEL NUMBER: _____

SERIAL No: _____

POINT OF SALE (NAME/LOCATION): _____

DATE OF PURCHASE: _____

INSTALLATION PERFORMED BY: _____

DATE OF INSTALLATION: _____

VEHICLE MAKE: _____

VEHICLE MODEL: _____

VEHICLE YEAR OF MANUFACTURE: _____

