



# RHINO-RACK

**CONTROLLED**

**Holden Colorado  
Isuzu DMAX - RIDB1**



**Important:** Please read these instructions carefully prior to installation. Please refer to your fitting instruction to ensure that the Backbone System is installed in the correct location. Check the contents of kit before commencing fitment and report any discrepancies. Place these instructions in the vehicle's glove box after installation is complete.

## Layout

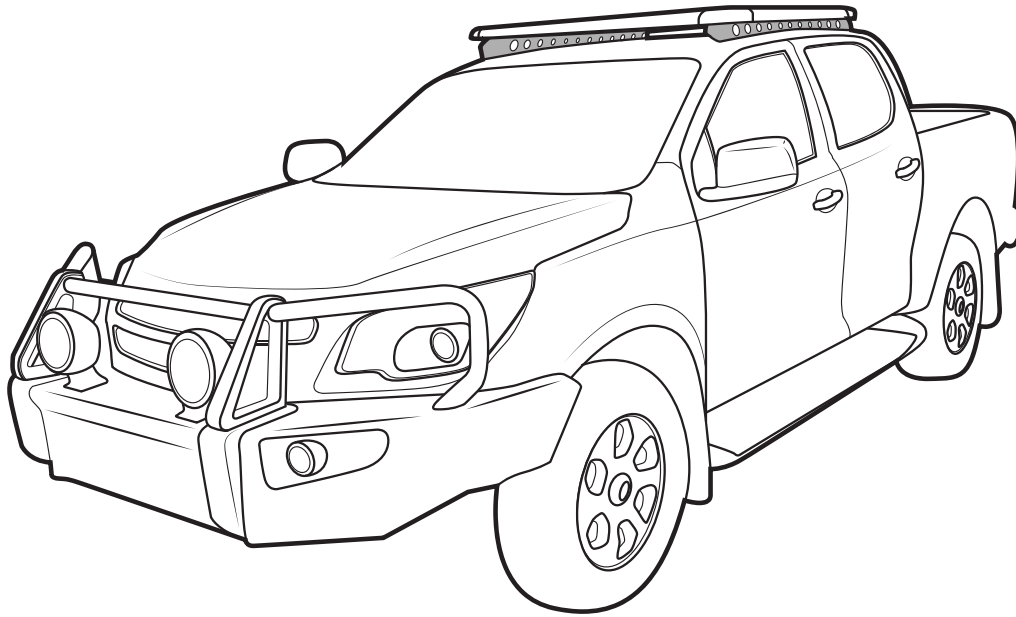

**Maximum load carrying capacity: 100kg / 220lbs**

## Important Information

- 1.  Check Part No./Kit is correct
- 2.  Read through instruction before installing
- 3.  Fit roof rack accessory
- 4.  Check and recheck all fasteners are secure

**Maximum carrying capacity:** 100kg (220lbs) including the weight of the rack system 25kg (55lbs). **Static Load Rating: 320kg/ 700lbs**  
Please refer to your vehicle manufacturers handbook for maximum carrying capacity. Always use the lower of the two figures. Load must be evenly distributed over the entire basket.

**Warning:** Do not attempt to fit the rack system to your vehicle unless you fully understand these fitting instructions. Please direct any questions regarding fitting to the dealer from where the roof racks were purchased.

**Use only non-stretch fastening ropes or straps.**

**Recommendations:** It is essential that all bolt connections be checked after driving a short distance when you first install your roof racks. Bolt connections should be checked again at regular intervals (once a week is enough, depending on road conditions, usage, loads and distances travelled). You should also check the roof racks each time they are re-fitted. Always make sure to fasten your load securely. Please also ensure that all loads are evenly distributed and that the centre of gravity is kept as low as possible and must be entirely contained within the extents of the roof racks.

**Rack System must be removed when putting vehicle through an automatic car wash.**

**Caution:** The handling characteristics of the vehicle changes when you transport a load on the roof. For safety reasons we recommend you exercise extreme care when transporting wind-resistant loads. Special consideration must be taken into account when cornering and braking.

### Off-road use:

The Backbone Rack System may be used in off road applications, however a safety factor of 1.5 is enforced. That is, maximum permissible off road load is **66kg (145lbs)**. Although the crossbars are tested and approved to AS1235-2000/ 15011154, off-road conditions can be much more rigorous. Extreme care must be taken in off road conditions

### Note for Dealers and Fitters:

It is your responsibility to ensure these fitting instructions are given to the end user or client.

Rhino-Rack 3 Pike Street, Rydalmere,  
NSW 2116, Australia.  
(Ph) (02) 9638 4744  
(Fax) (02) 9638 4822

Document No: R945  
Prepared By: W.Davis  
Authorised By: Chris Murty

Fit Time: 1.5 hours  
Issue No: 04  
Issue Date: 16/01/2017

These instructions remain the property of Rhino-Rack Australia Pty. Ltd. and may not be used or changed for any other purpose than intended.



# Holden Colorado, Isuzu DMAX - RIDB1

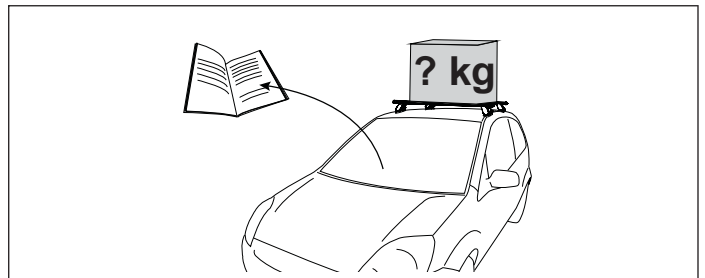
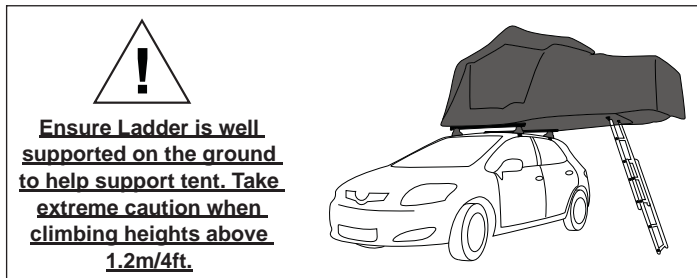
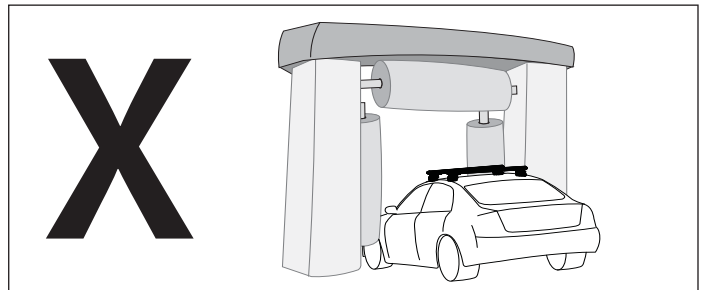
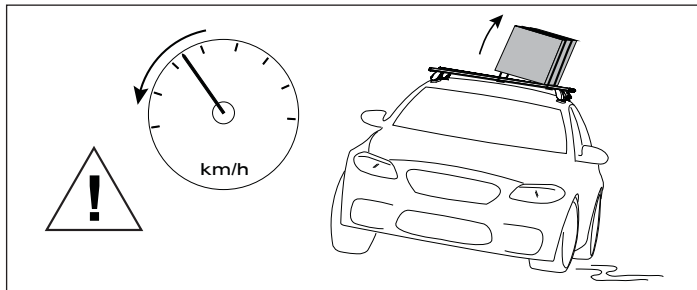
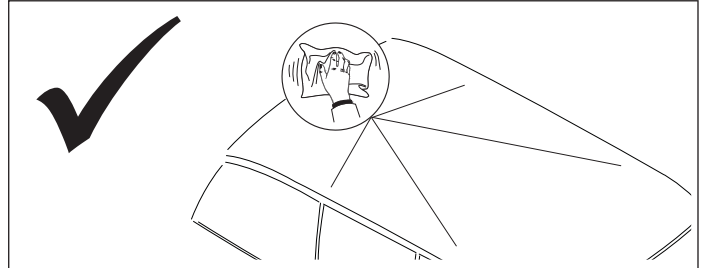
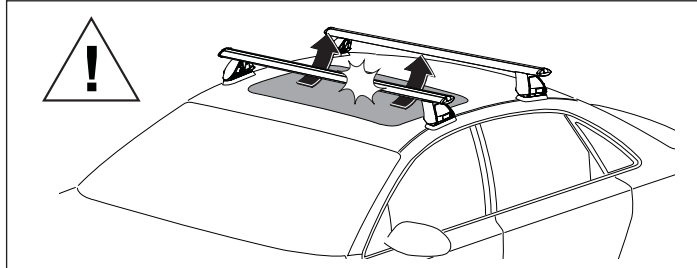
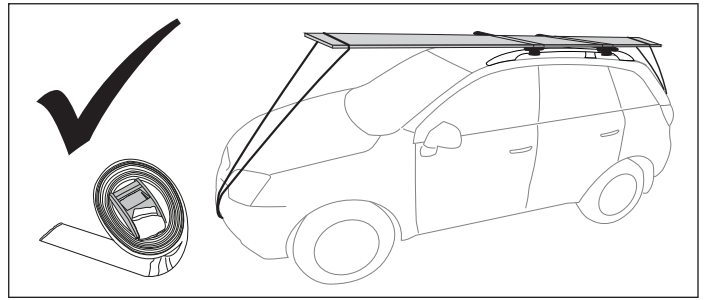
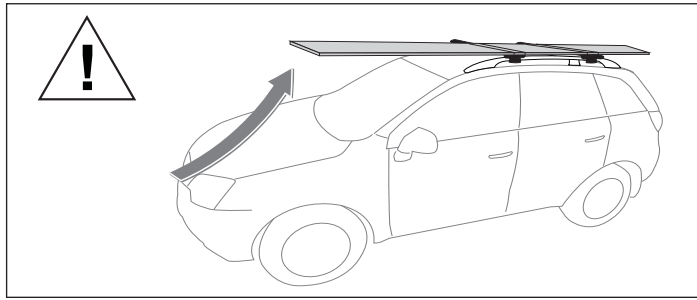

When these roof racks are to be used on a vehicle that is driven off sealed roads, the manufacturer maximum roof load rating (to be found in the vehicles User Manual) should be **divided by 1.5**. Do not forget to subtract the complete crossbar system weight from your maximum carrying capacity.

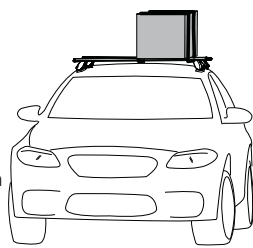

$$100\text{kg}/220\text{lbs (Urban Road)} = 66\text{kg}/147\text{lbs (Off Road)}$$

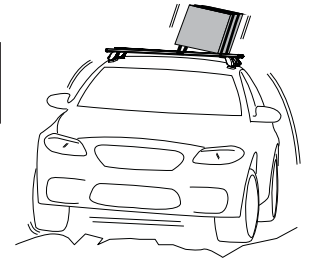

## WARNING! Important Load Carrying Instructions

With utility vehicles, the cabin and the canopy move independently. Roof racks and vehicle can be damaged if the item transported is rigidly fixed at points on both the cabin and canopy. Instead, rigidly fix to either the cabin roof racks or the canopy roof racks.

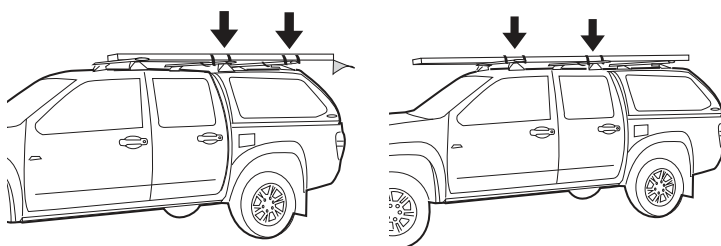

Paddle/ Surfboards should be fixed to the front of the vehicle.

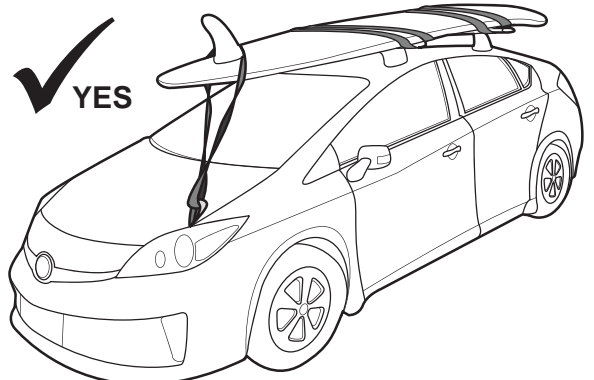



# Holden Colorado, Isuzu DMAX - RIDB1

## Parts List

Item	RIDB1	Qty	Part No.
1	Colorado/DMAX Backbone LH	1	CA1513
2	Colorado/DMAX Backbone RH	1	CA1514
3	Butyl Patch 40x25mm 7mm Hole	4	CA1260
4	M8 Channel Nut	4	N003
5	M8x19x2.5mm Flat Washer	4	W043
6	M8 Spring Washer	8	W019
7	M8x25mm Hex Setscrew	4	B169
8	M8x20mm Socket Head Screw	4	B031
9	M8x17mm Flat Washer	4	W020
10	Short 6mm Allen Key	1	H050
11	Instructions	1	R804

For use with Pioneer 42100. Pioneer range sold as separate.

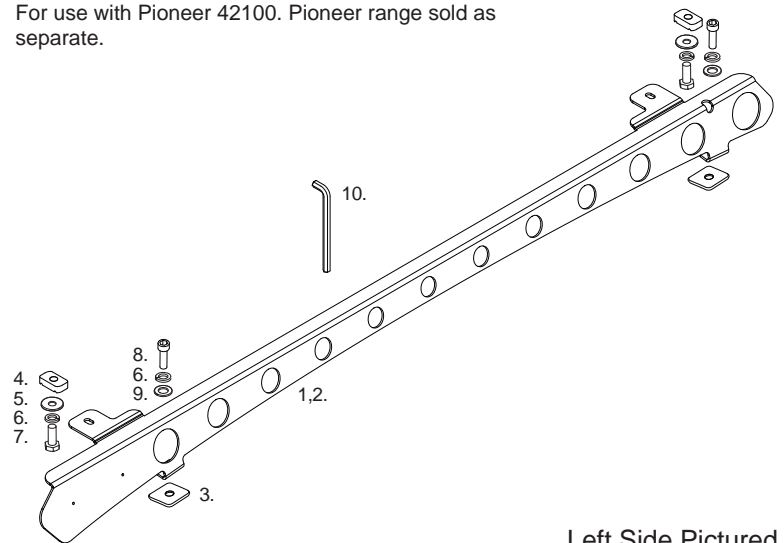

Left Side Pictured

### Tools Required:

1. 13mm Spanner
2. Marker
3. Nylon Scrape
4. Cutters
5. 6mm Ball End Allen Key
6. Trim Removal Tools

## Holden Colorado Z71 Rail Removal

- 1 For Vehicles without Roof Rails - Skip to Step 4. (Note for models with roof rails be sure to have SUB0709 kit on hand).

Remove plastics covers from roof rails. Extreme caution must be used when removing cover and rail. The roof panels are extremely soft and can easily be deformed.

The plastic covers are fixed using 4 internal plastic clips. Disengage the clips by first levering the inside of the cover outwards, using a second trim removal tool, place under the cover and slide horizontal whilst pulling up. **Do NOT lever against body work.**

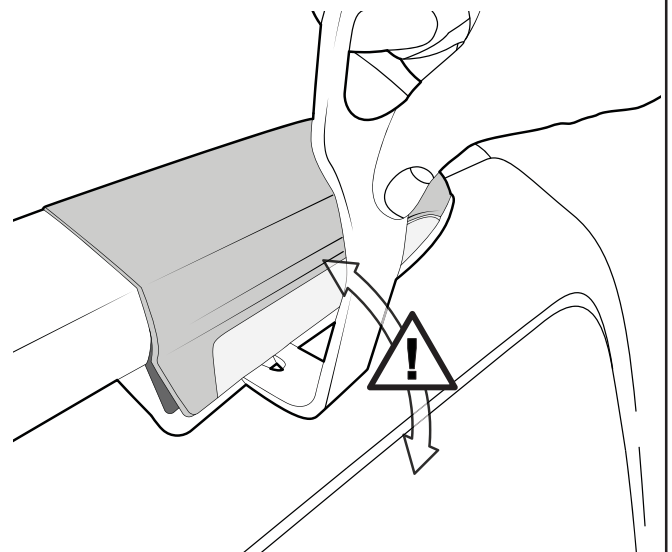
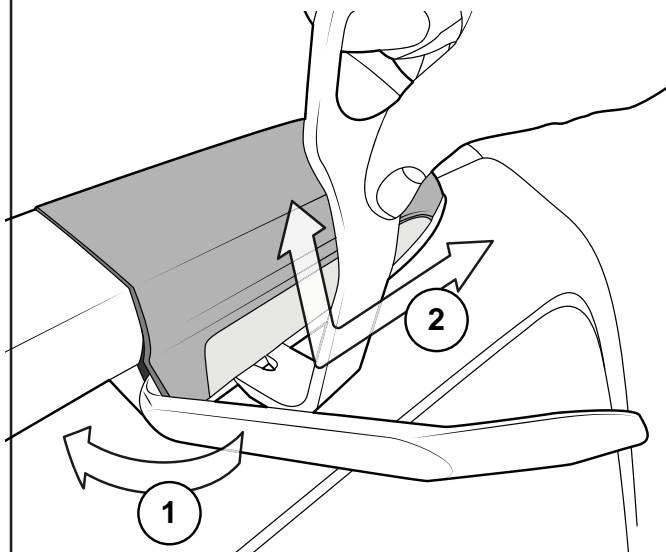

INSIDE

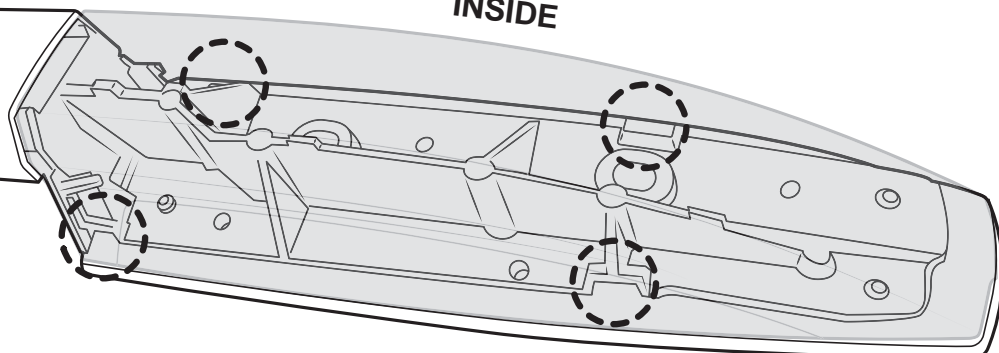



# Holden Colorado, Isuzu DMAX - RIDB1

**2** Remove Torx bolts using T50 Torx key.

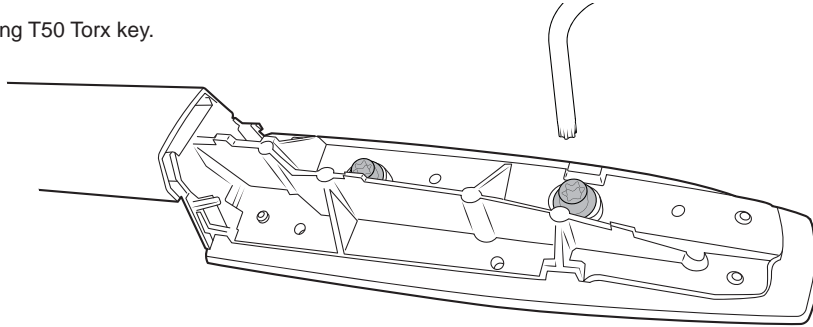

**3** Once bolts have been loosened and removed - LIFT rail vertically to remove. Do NOT roll rail backwards or forwards to remove as this will damage the bodywork. The gutter strip under the roof rail is factory cut and will NOT extend to the feet of the Backbone. A gap in the gutter strip will be present. Install SUB0709 kit into the open threads. Once complete - move to step 7.

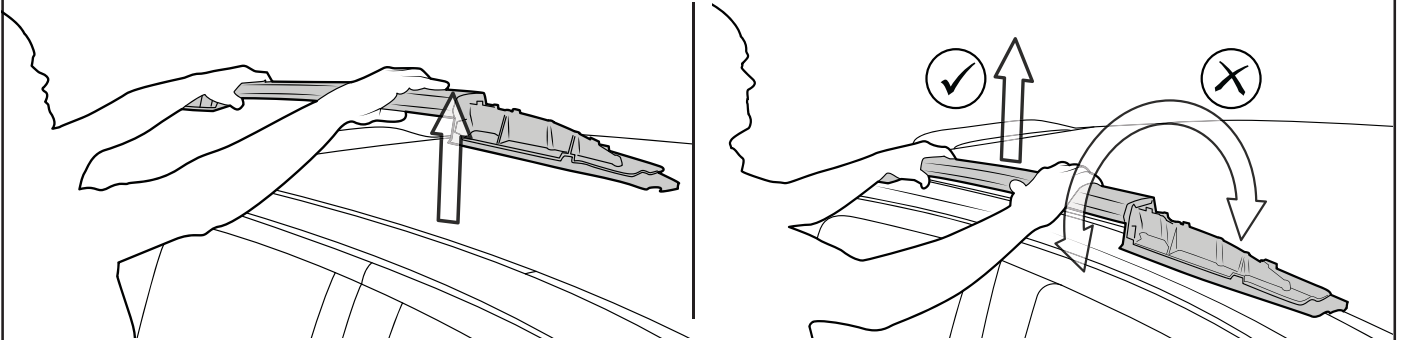

## Instructions

**4** Starting at the Door Jamb measure out to the locations below and use a marker to create cutting references on the Ditch Mould.

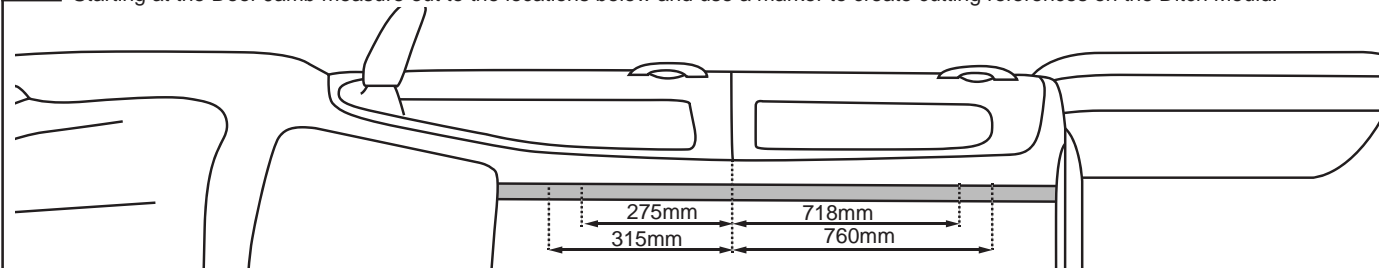

**5** With the assistance of a second person, peel back the inside edge of the gutter at the area where the Ditch Mould needs to be cut. Carefully, using sharp cutters, cut the inside edge of the Ditch Moulding.

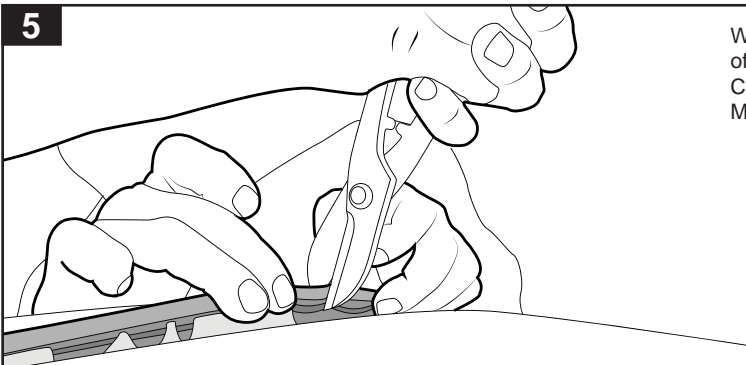

Use extreme caution when using cutters. Ensure the tool does not touch any vehicle paintwork.

**6** Repeat step 2 - pushing the ditch moulding forward and completing the remainder of the cut. Repeat for all marks on ditch moulding prepared in Step 4

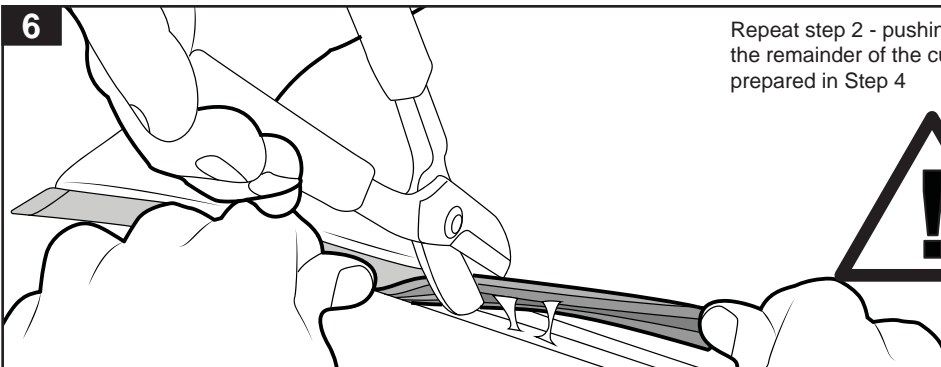

Use extreme caution when using cutters. Ensure the tool does not touch any vehicle paintwork.



# Holden Colorado, Isuzu DMAX - RIDB1

**7** For Holden Colorado Only (see step 8a,b and c for Isuzu DMAX): Locate the four Factory Mount Points in the Ditch, these will be covered by painted Butyl Patches. Using the Allen Key provided, carefully push through the Patches and expose the threads below. Remove any material within. Using an M8 Socket Screw, test all exposed threads for binding. Clean threads if required.

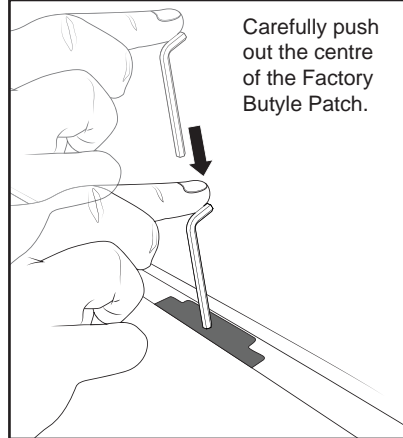
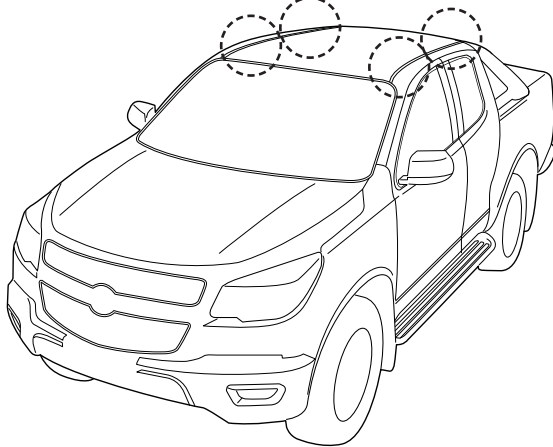

Carefully push out the centre of the Factory Butyle Patch.

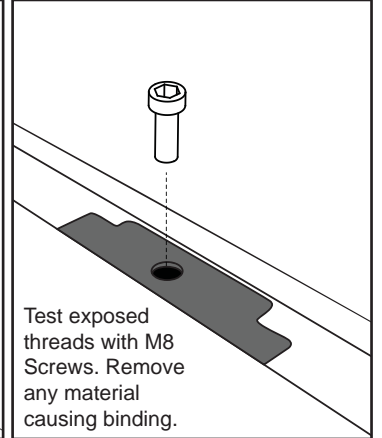

Test exposed threads with M8 Screws. Remove any material causing binding.

**8a** For Isuzu D-MAX: 1 - Measure back along the Ditch from the front of the vehicle, 350mm as shown. Spot drill the centre of the Ditch at this point with a 3mm Drill Bit. Measure back from here a further 1032mm and spot drill at that point. 2 - Open out these spot marks with a 7mm Drill Bit.

Top View:

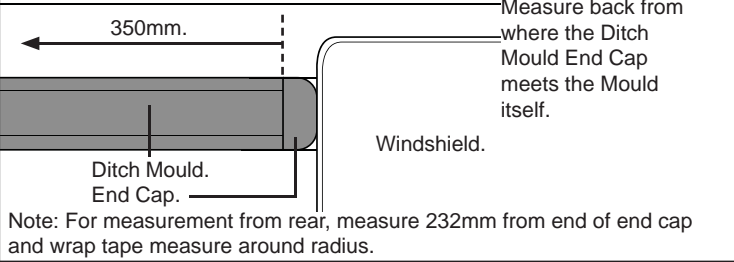

Note: For measurement from rear, measure 232mm from end of end cap and wrap tape measure around radius.

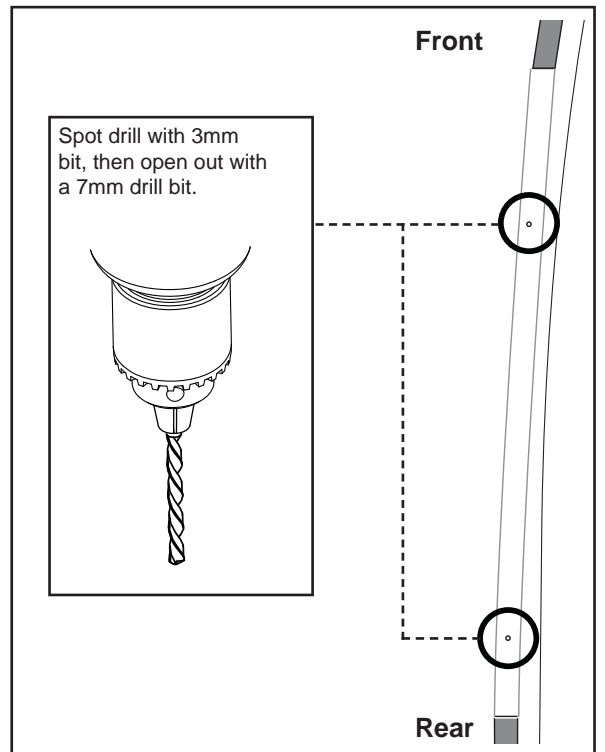
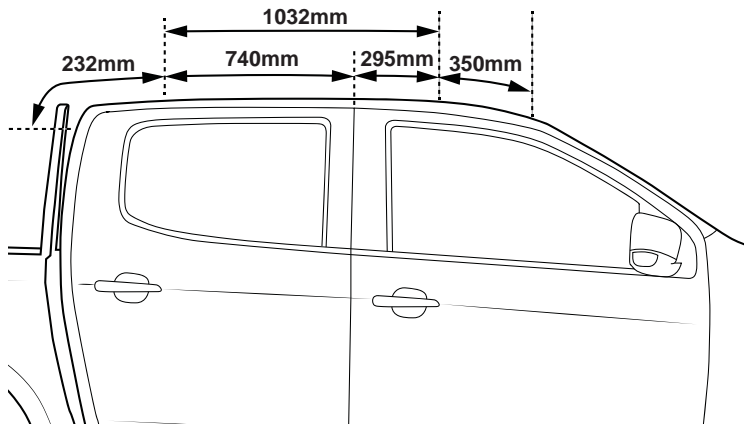

**8b** Dye Grind the opened holes from the previous steps. This will expose the Nutserts below.

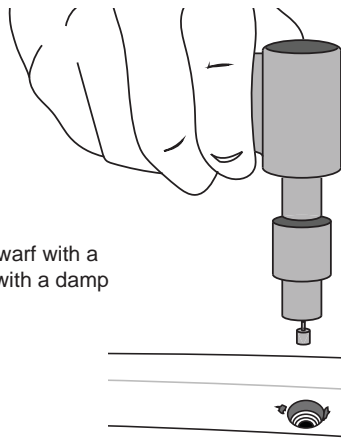

Note: Remove all swarf with a vacuum then wipe with a damp microfibre cloth.

**8c** Apply a liberal amount of cold galvanizing solution to the inside and surrounds of all holes. Allow cold galvanizing solution to dry as per instructions (5-10 mins).

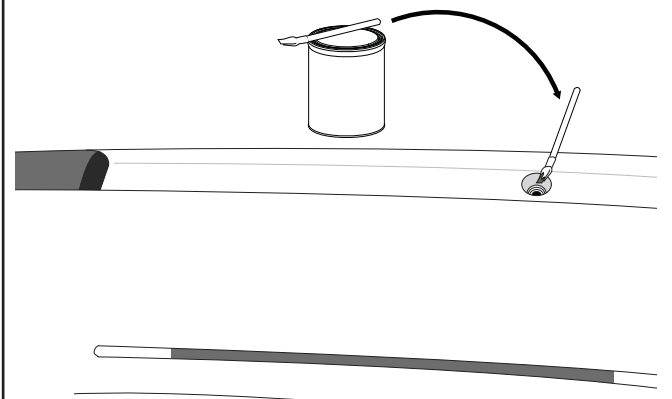



## Holden Colorado, Isuzu DMAX - RIDB1

- 9** Remove one side of protective tape from the Butyl Patches provided. Place carefully over the exposed threads. Remove the top layer of protective tape from the installed Patches.

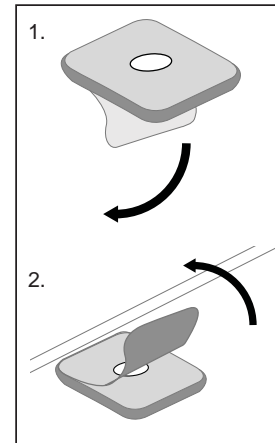
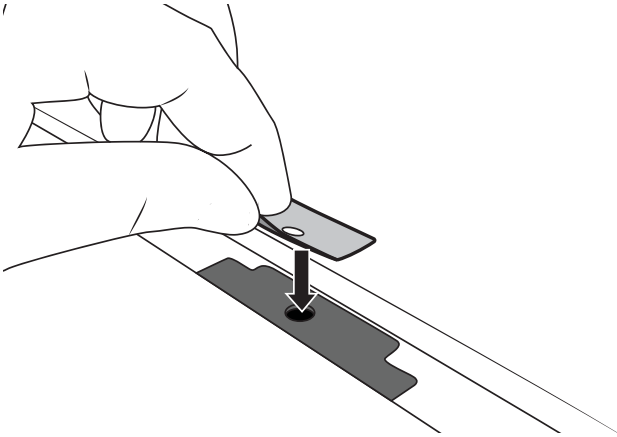

- 10** Place the Backbone onto the vehicle. Be sure to use correct orientation. 1: Finger tighten in place with M8 Socket head Screws, M8 Spring and Flat Washers. 2: Tighten with Allen Key. The hardware can be accessed easily from the outside of vehicle as shown with a long ball end allen key. Be sure all fixtures are secure.

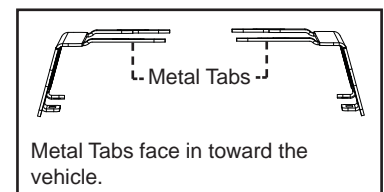
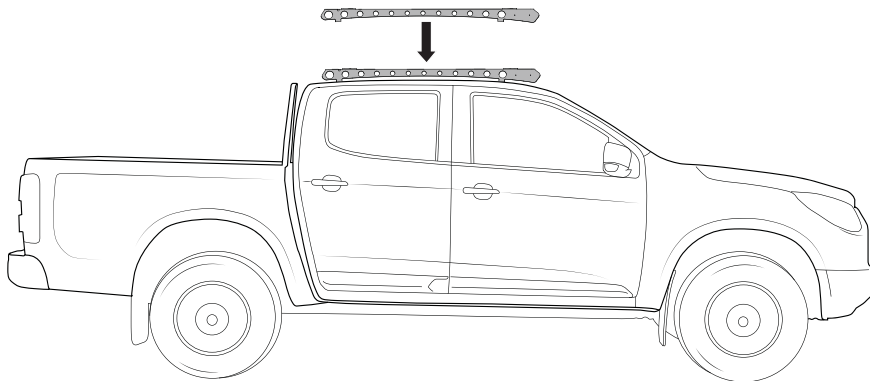
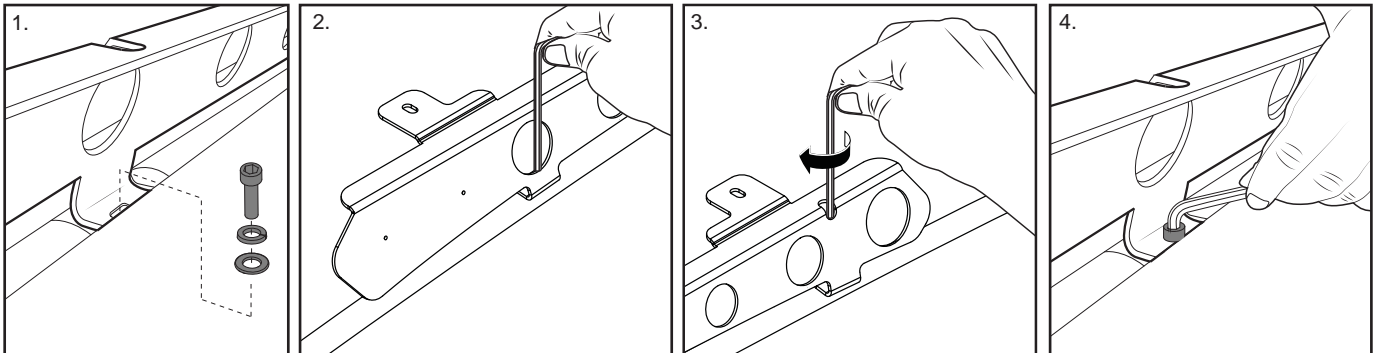

- 11** Repeat previous steps for securing opposite side Backbone rail.

Ensure both Assemblies are securely positioned on the car. Check each bolt before proceeding to attaching the Pioneer Platform to the Backbone.

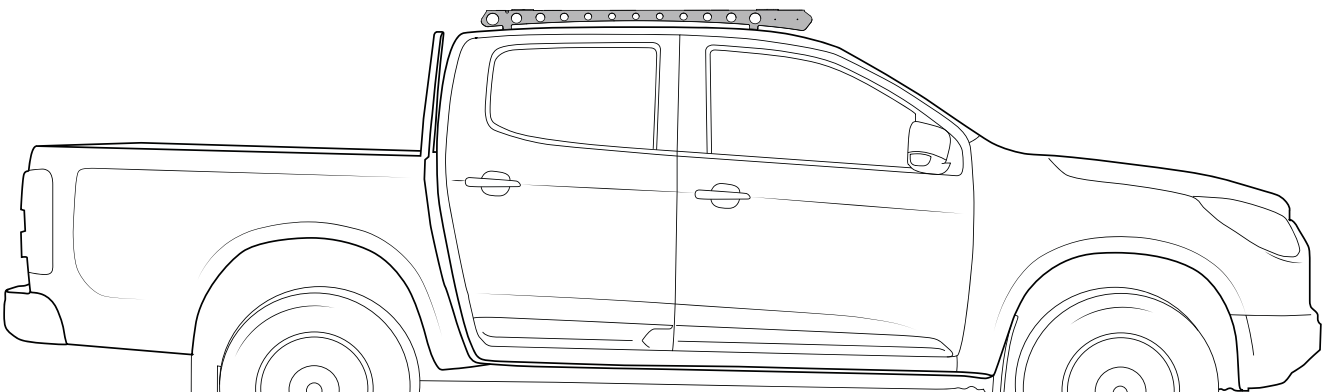



## Holden Colorado, Isuzu DMAX - RIDB1

- 12** Assemble M8 hardware as pictured below. Complete this for the six tabs on top of the backbone rails (2 each rail).

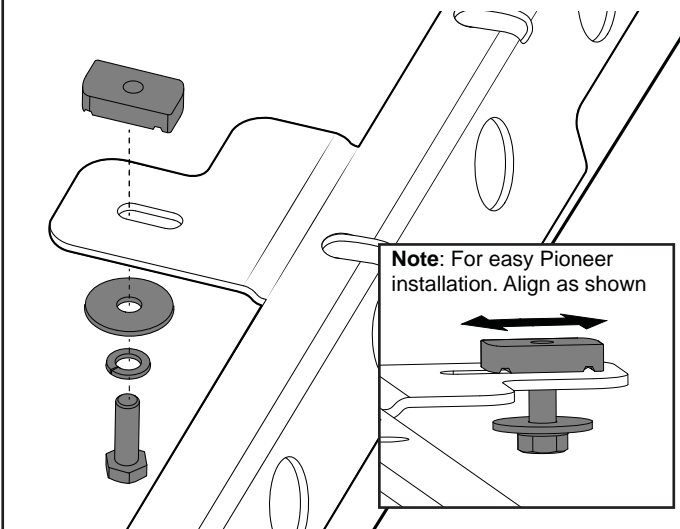

- 13** Install Pioneer Underbars with slots indicated (42100  
**REAR:** 125mm from Rear (using slots)  
**FRONT:** 100mm from Front (drill)

The rear slot will have to be drilled with an 8.5mm drill bit. For detailed underbar installation instructions, refer to Pioneer fitting instructions.

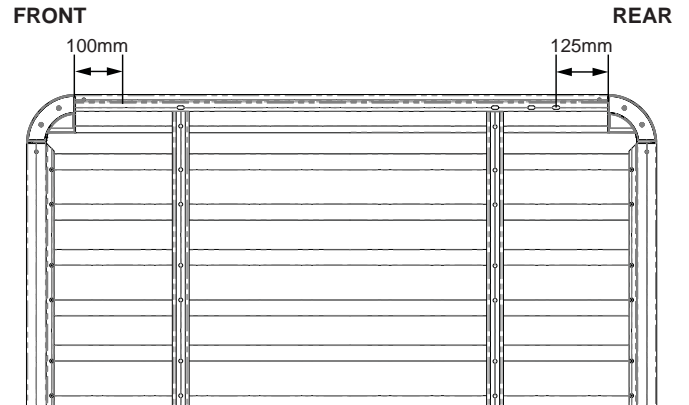

- 14** After underbars have been correctly fitted, place the Pioneer Platform on top of the Backbone. Align the underbars with the top tabs and ensure the M8 hardware fits into underbar channel.

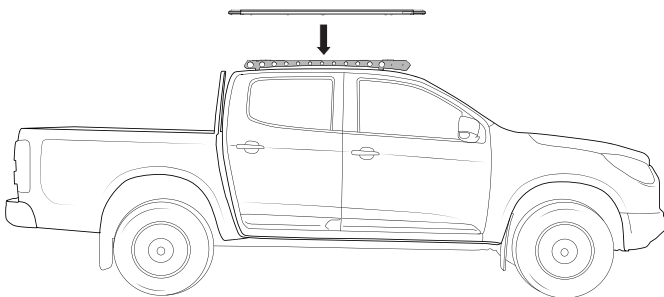

- 15** Once Pioneer Underbars have been aligned properly, tighten all M8 hardware using 13mm socket wrench or 13mm spanner. Ensure channel nut has rotated within Pioneer underbar and is fixing Pioneer securely.

